

DISTRICT	COUNTY	ROUTE	PROJECT	SHEET
4-0	SUSQUEHANNA	I-81	GREAT BEND TOWNSHIP	
REVISIONS				

SYMBOLS

- Existing Sign to Remain
- △ Existing Sign to be Removed
- ◻ Existing Sign Reset as Shown
- NEW SIGN
- ✕ FUTURE SIGN
- ⊘ Existing Utility Pole

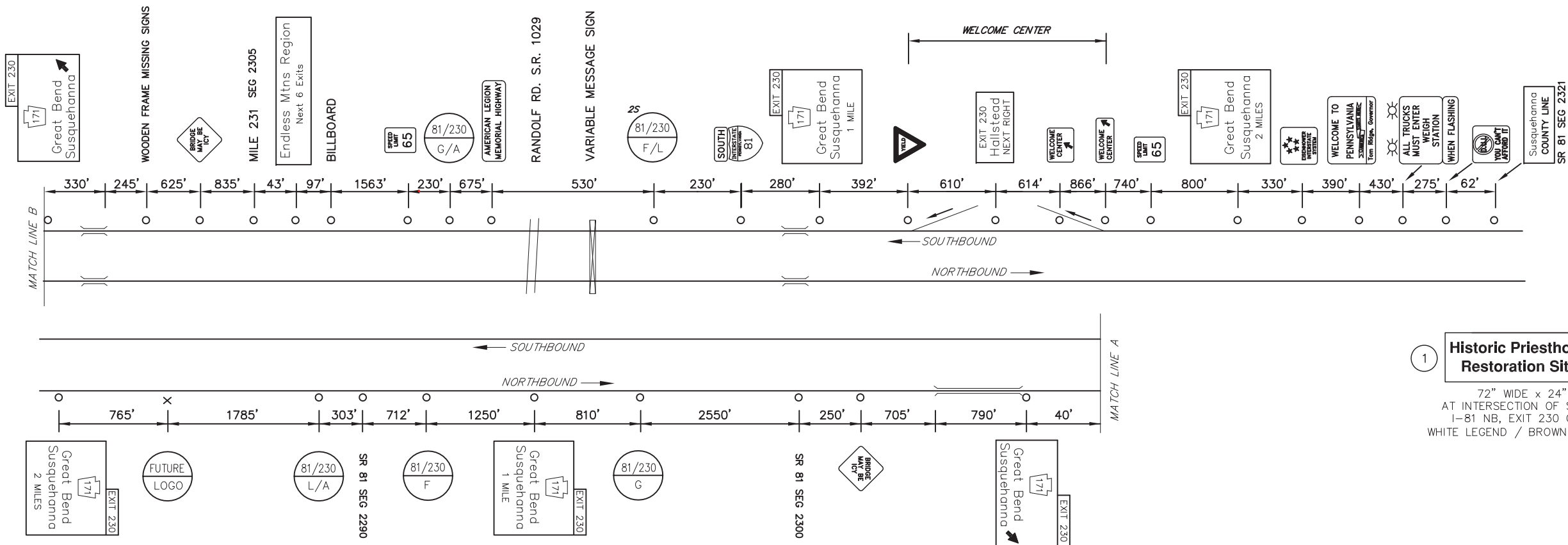

MAINLINE SCHEMATIC
NOT TO SCALE

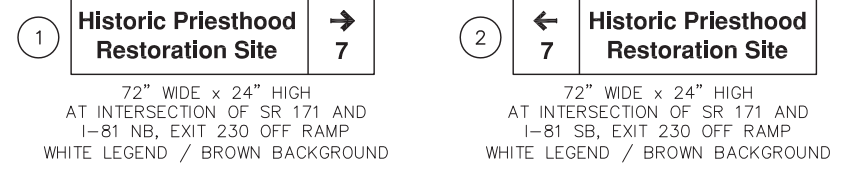

TODS PANELS
NOT TO SCALE

TABULATION OF QUANTITIES		
ITEM	UNIT	QUANTITY
POST MOUNTED SIGNS, TYPE A, LOGO	SQ.FT.	-
POST MOUNTED SIGNS, TYPE B, LOGO	SQ.FT.	-
POST MOUNTED SIGNS, TYPE C, LOGO	SQ.FT.	-
BREAKAWAY SYSTEMS	EACH	-
* STEEL S OR W BEAM POSTS	LBS.	-
LOGO SIGN MOUNTING	EACH	-
REMOVAL OF POST MOUNTED MOTORIST SERVICE SIGNS, TYPES B, C & F	L.S.	-

* APPROXIMATE QUANTITY FOR INFORMATION ONLY

EXIT 230 SPECIFIC INFORMATION PANEL			
SIGN NUMBER	LEGEND	BUSINESS	LOGO. NO.
81/230 L NB 81/230 L SB	LODGING	COLONIAL BRICK INN & SUITES	1
81/230 A NB 81/230 A SB	ATTRACTION	PRIESTHOOD RESTORATION SITE	9
81/230 G NB 81/230 G SB	GAS	EXXON (24 Hr/Diesel)	2
		VALERO (24 HOURS)	3
81/230 G NB	GAS	SUNOCO (24 HRS/DIESEL)	4
81/230 F NB 81/230 F SB	FOOD	TIM HORTON'S (24 HOURS)	5
		BURGER KING	6
		McDONALD'S	7
		DUNKIN' DONUTS	8

NB SIGNS

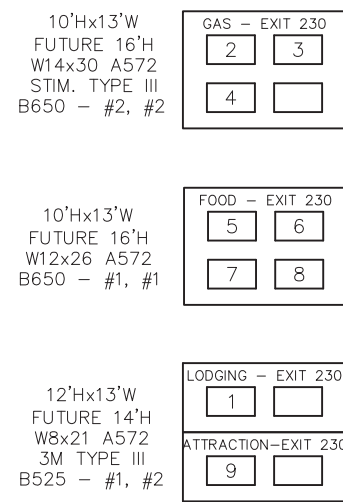

SB SIGNS

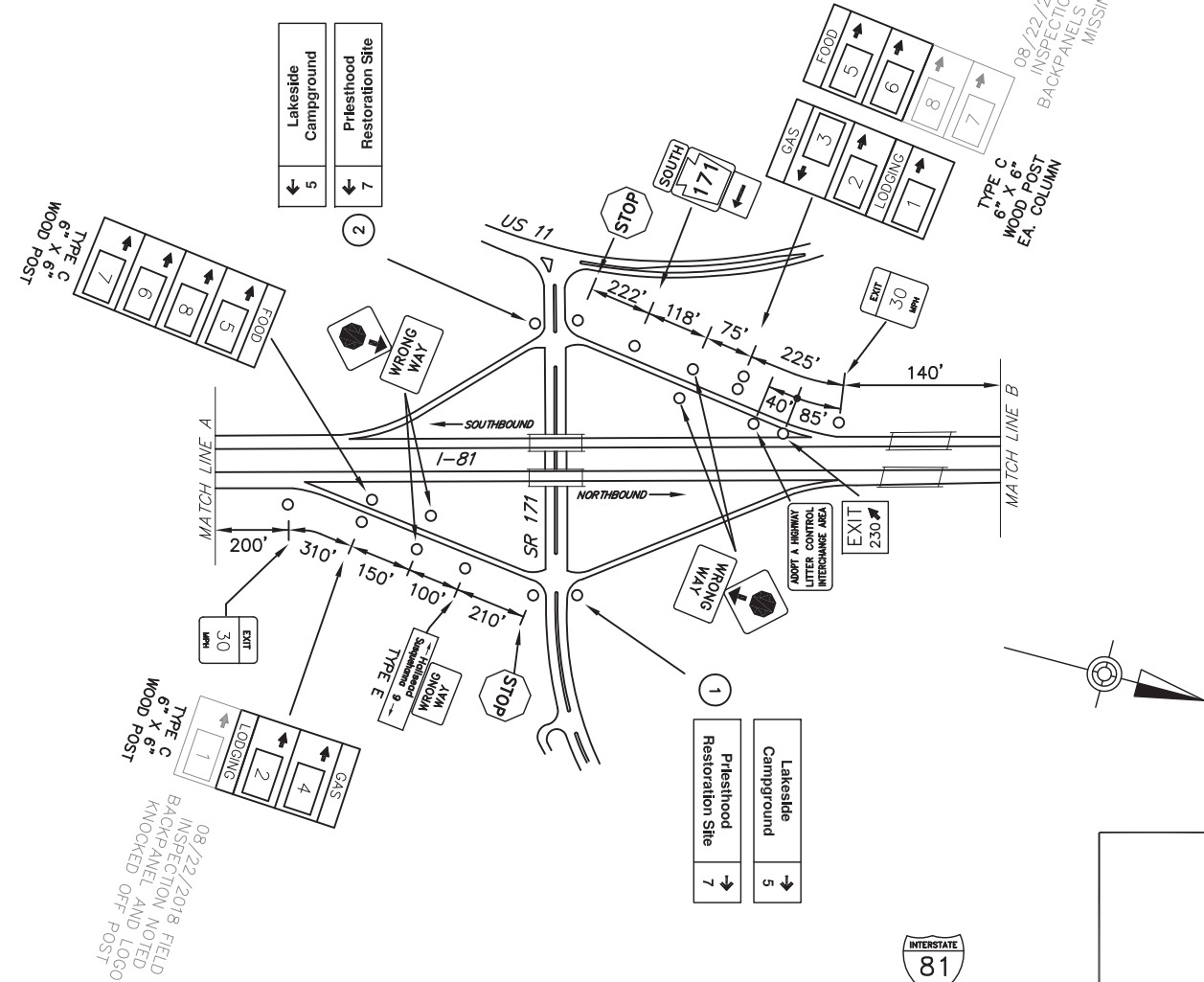
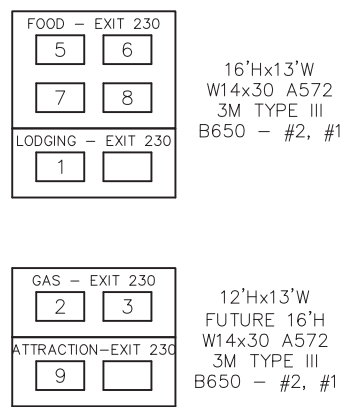

SCHEMATIC PLAN
NOT TO SCALE

INTERSTATE 81
GREAT BEND / HALLSTEAD
EXIT 230

05:00:00 08/22/2018 11:45:00 AM - BUILT: DRAWINGS/PERMITS - DISTRICT: 04/SUSQUEHANNA - 57-UP-XX - SR171-IBL-EXIT230 PLAN - September 4/2018 2:43 PM