

| DISTRICT | COUNTY | ROUTE | PROJECT | SHEET |
|-------------------|--------|-------|---------|-------|
| 6-0 | BUCKS | I-95 | | |
| BENSALEM TOWNSHIP | | | | |
| REVISIONS | | | | |
| | | | | |
| | | | | |

NO ADD'L SB SIGN LOCATIONS EXIST FOR THE LOGO PROGRAM.

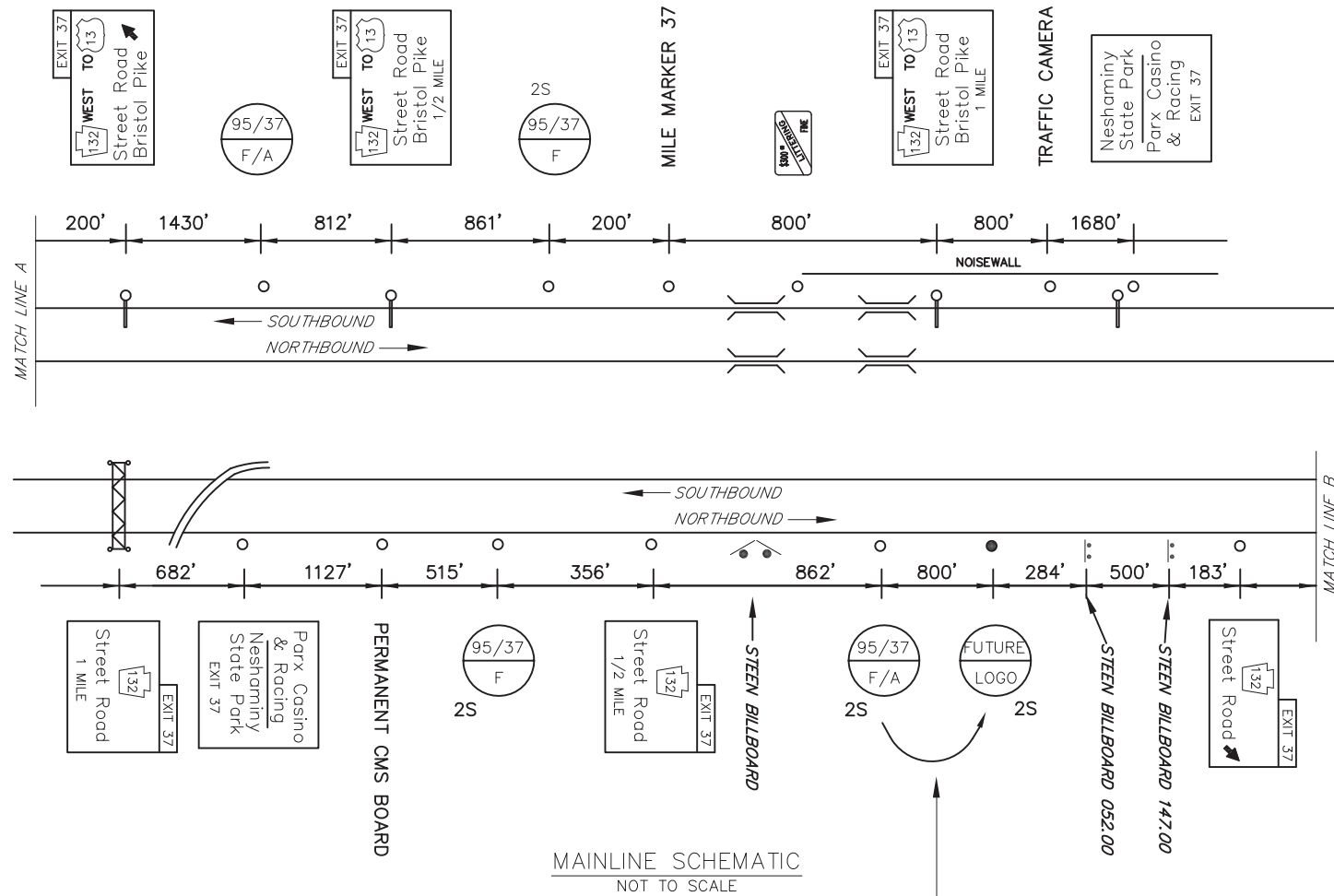

| ITEM | UNIT | QUANTITY |
|--|--------|----------|
| POST MOUNTED SIGNS, TYPE A, LOGO | SQ.FT. | |
| POST MOUNTED SIGNS, TYPE B, LOGO | SQ.FT. | |
| POST MOUNTED SIGNS, TYPE C, LOGO | SQ.FT. | |
| BREAKAWAY SYSTEMS | EACH | |
| * STEEL S OR W BEAM POSTS | LBS. | |
| LOGO SIGN MOUNTING | EACH | |
| FLAT SHEET PANEL REPLACEMENT | SQ.FT. | |
| EXTRUDED PANEL REPLACEMENT | SQ.FT. | |
| REMOVAL OF POST MOUNTED MOTORIST SERVICE SIGNS, TYPES B, C & F | L.S. | |

* APPROXIMATE QUANTITY FOR INFORMATION ONLY

| | |
|---|------------------------------|
| ○ | Existing Sign to Remain |
| △ | Existing Sign to be Removed |
| ◻ | Existing Sign Reset as Shown |
| ● | NEW SIGN |
| × | FUTURE SIGN |
| ∅ | Existing Utility Pole |

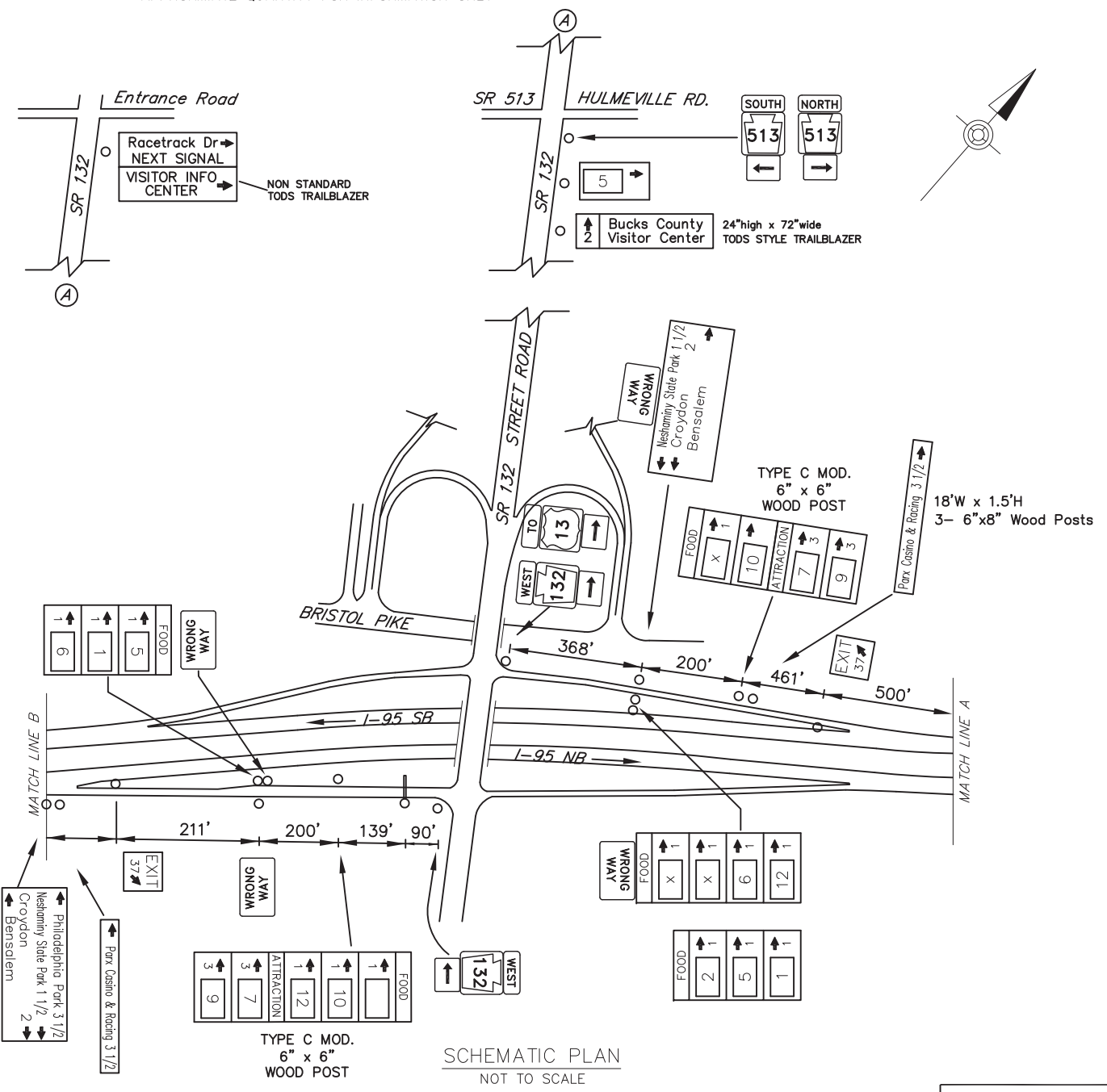

PROPOSED NEW WORK:
 CONSTRUCT NEW FOOTERS & SUPPORTS.
 MOVE 6'Hx19'W ATTRACTION PANEL FORWARD TO NEW LOCATION (add Gas or Lodging in Future).
 EXPAND 6'Hx19'W FOOD PANEL TO 10' HEIGHT. NB MAINLINE WOULD HAVE 12 FOOD SPACES.

| SIGN NUMBER | LEGEND | BUSINESS | LOGO. NO. |
|-------------|------------|-----------------------------|-----------|
| 95/37 F NB | FOOD | McDONALDS | 1 |
| | | PANERA BREAD | 2 |
| | | FRIENDLY'S | 6 |
| | | DUNKIN' DONUTS (24 HOURS) | 5 |
| | | GOLDEN CORRAL | 10 |
| 95/37 F SB | FOOD | KRISPY KREME DOUGHNUTS | 12 |
| | | BUCKS COUNTY VISITOR CENTER | 7 |
| 95/37 A NB | ATTRACTION | PARX CASINO & RACING | 9 |
| | | | |
| 95/37 A SB | ATTRACTION | | |

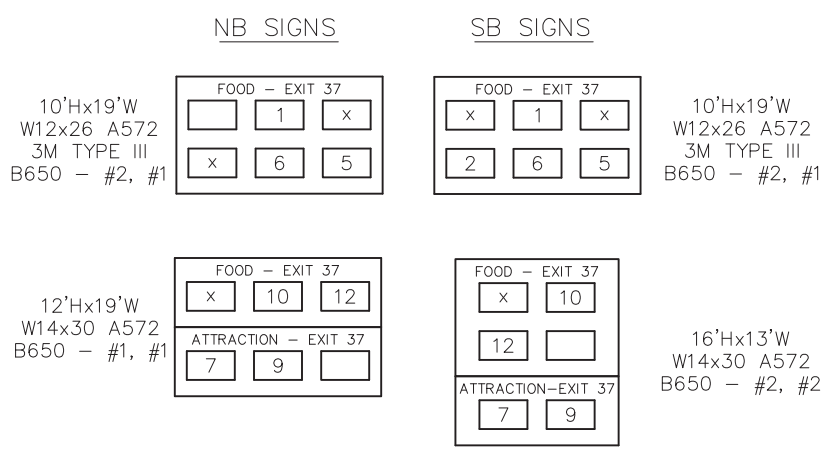

D:\DATA\PROJECTS\PA132\PA132-EXIT 37\PA132-EXIT 37 PLAN.dwg
 12/10/2018 11:49 AM
 DISTRICT 06/BUCKS - 09/10/08 SH/TK/RS/MS/PA132-EXIT 37 PLAN