

DISTRICT	COUNTY	ROUTE	PROJECT	SHEET
10-0	BUTLER	US 422		
BUTLER TOWNSHIP REVISIONS				

ITEM	UNIT	QUANTITY
* STEEL S OR W BEAM POSTS	LBS.	-
BREAKAWAY SYSTEMS	EACH	-
POST MOUNTED SIGNS, TYPE A, LOGO	SQ.FT.	-
POST MOUNTED SIGNS, TYPE B, LOGO	SQ.FT.	-
POST MOUNTED SIGNS, TYPE C, LOGO	SQ.FT.	-
LOGO SIGN MOUNTING	EACH	-
EXTRUDED PANEL REPLACEMENT	SQ.FT.	-
REMOVAL OF POST MOUNTED MOTORIST SERVICE SIGNS, TYPES B, C & F	LS	-
	EACH	-

○	Existing Sign to Remain
△	Existing Sign to be Removed
◻	Existing Sign Reset as Shown
●	NEW SIGN
×	FUTURE SIGN
⊙	Existing Utility Pole

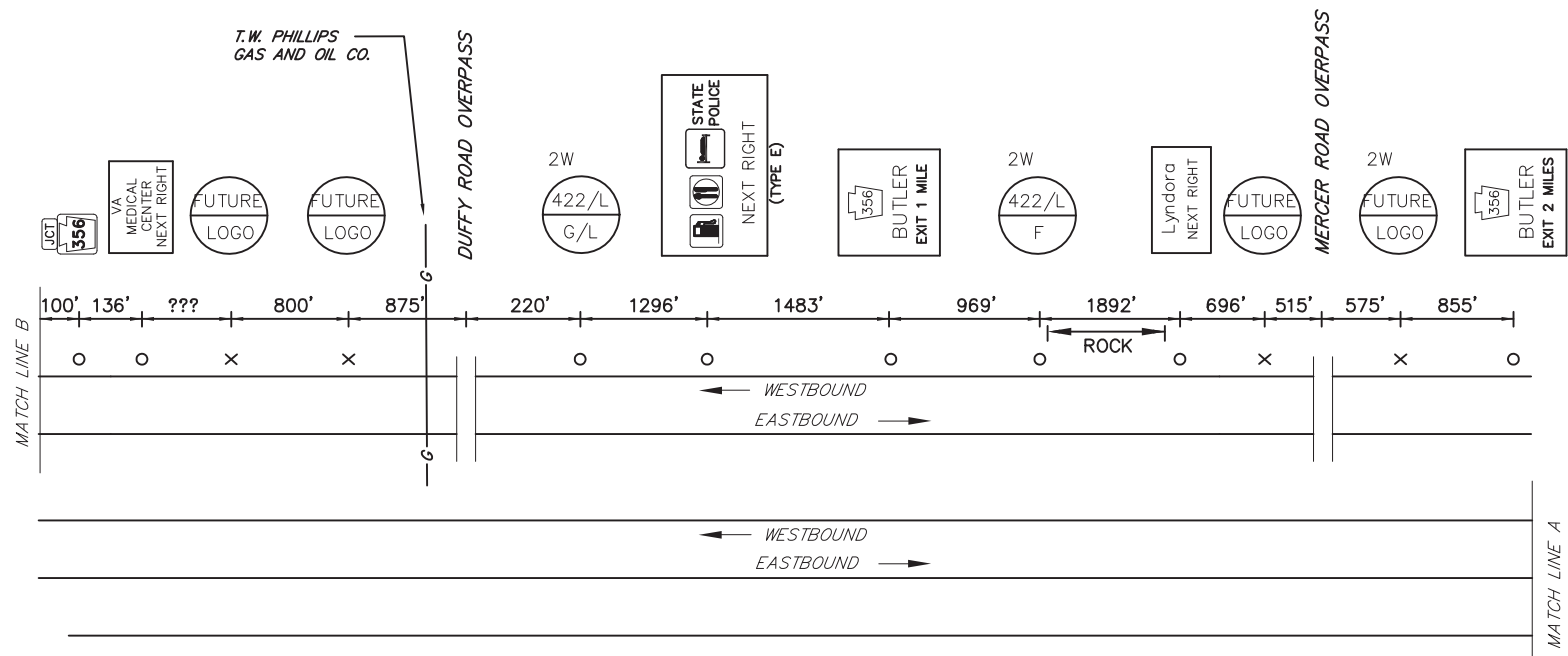

(EASTBOUND NOT ELIGIBLE, INSUFFICIENT SPACE)

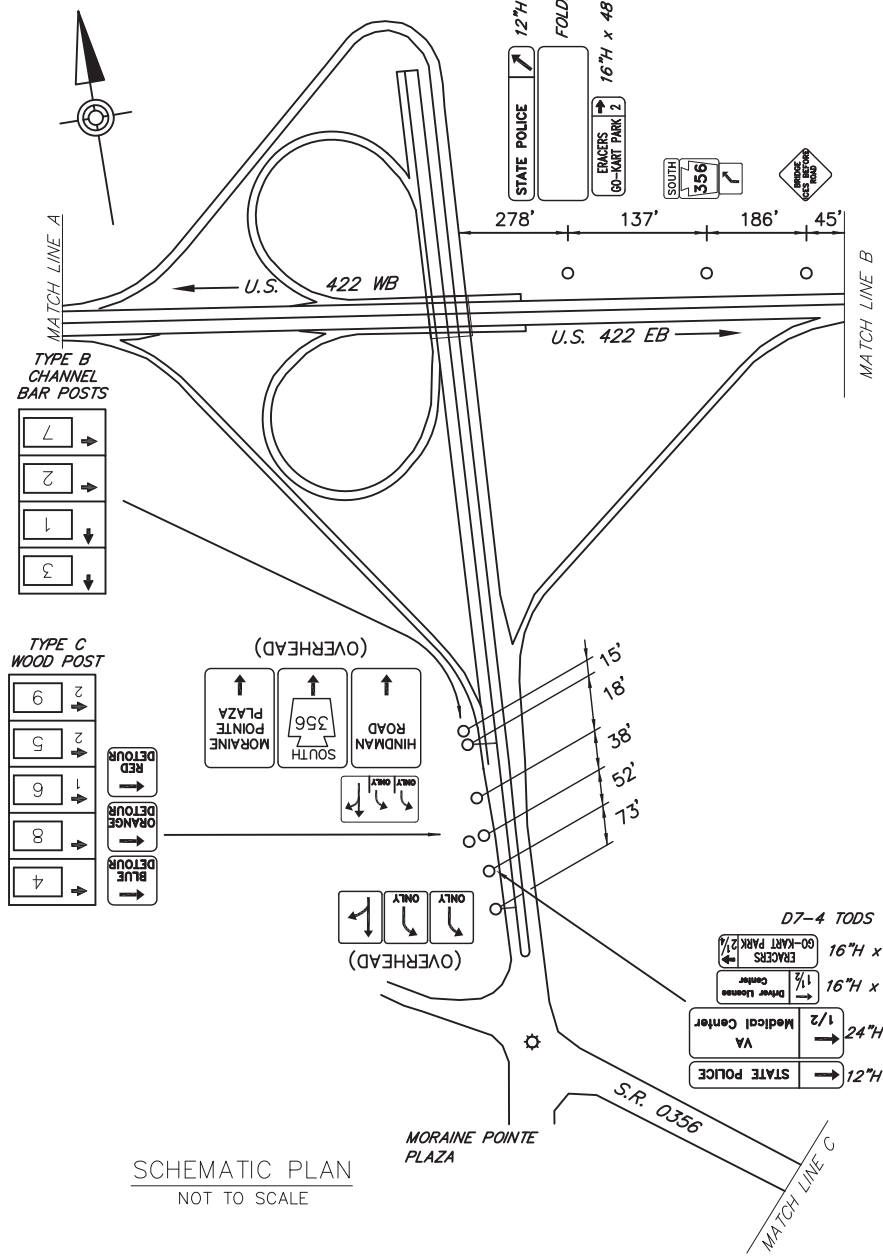
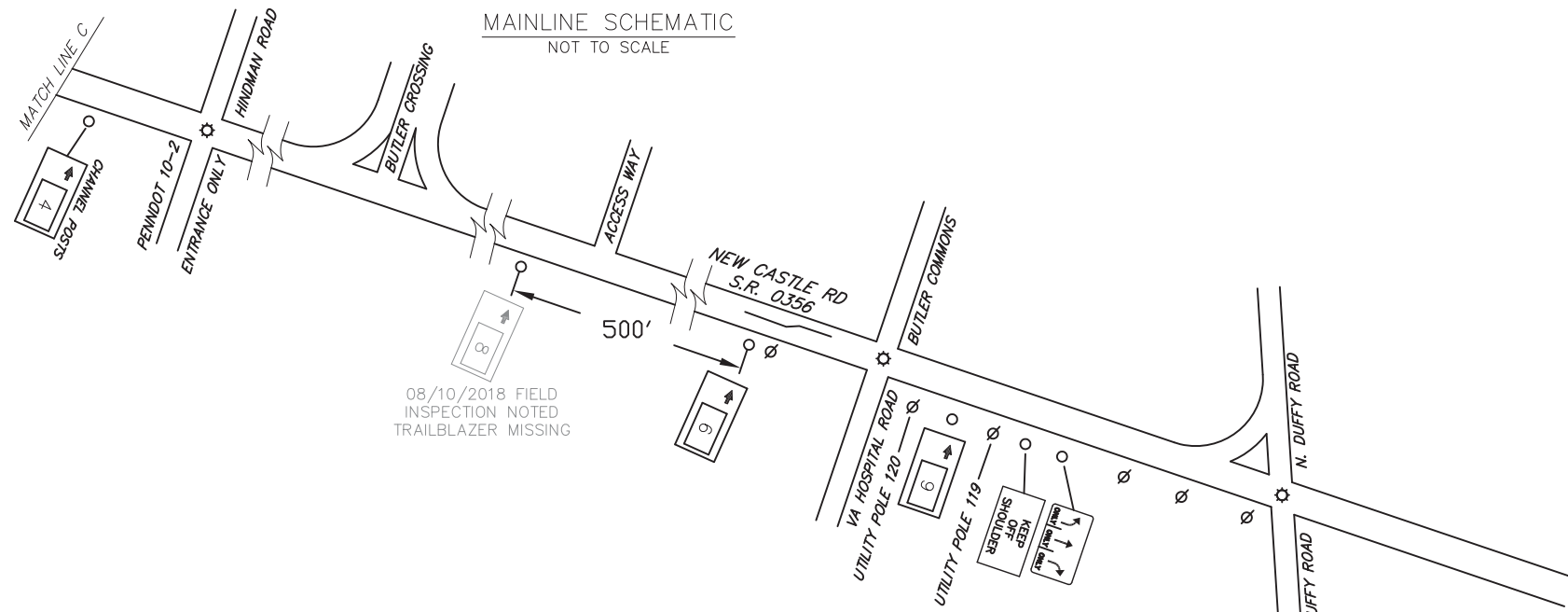

SIGN NUMBER	LEGEND	BUSINESS	LOGO. NO.
422/L G WB	GAS	SHEETZ	2
422/L F WB	FOOD	LONG JOHN SILVER'S	1
		RED LOBSTER	3
		McDONALD'S (24 HRS)	4
		EAT'N PARK (24 HRS)	5
		PANERA BREAD	6
		APPLEBEE'S	7
		HAMPTON INN	8
422/L L WB	LODGING	HOLIDAY INN EXPRESS	9

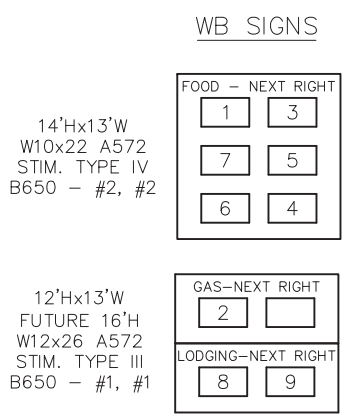

D:\BIDS\BIDS\2018\10-00\10-00-00\DRAWINGS\PERMITS-DISTRICT 10\BUTLER - 10-00-00-SITE-422-BUTLER PLAN 10-00-00-01.dwg 12/23/2018 1:01 PM