

DISTRICT	COUNTY	ROUTE	PROJECT	SHEET
9-0	CAMBRIA	US 219		
ADAMS AND RICHLAND TOWNSHIPS				

TABULATION OF QUANTITIES		
ITEM	UNIT	QUANTITY
* STEEL S OR W BEAM POSTS	LBS.	-
BREAKAWAY SYSTEMS	EACH	-
POST MOUNTED SIGNS, TYPE A, LOGO	SQ.FT.	-
POST MOUNTED SIGNS, TYPE B, LOGO	SQ.FT.	-
POST MOUNTED SIGNS, TYPE C, LOGO	SQ.FT.	-
LOGO SIGN MOUNTING	EACH	-
FLAT SHEET REPLACEMENT PANEL	SQ.FT.	-
EXTRUDED PANEL REPLACEMENT	SQ.FT.	-
REMOVAL OF POST MOUNTED MOTORIST SERVICE SIGNS, TYPES B, C & F	L.S.	-

\* APPROXIMATE QUANTITY FOR INFORMATION ONLY

**SYMBOLS**

- Existing Sign to Remain
- △ Existing Sign to be Removed
- ◻ Existing Sign Reset as Shown
- NEW SIGN
- × FUTURE SIGN
- ⊙ Existing Utility Pole

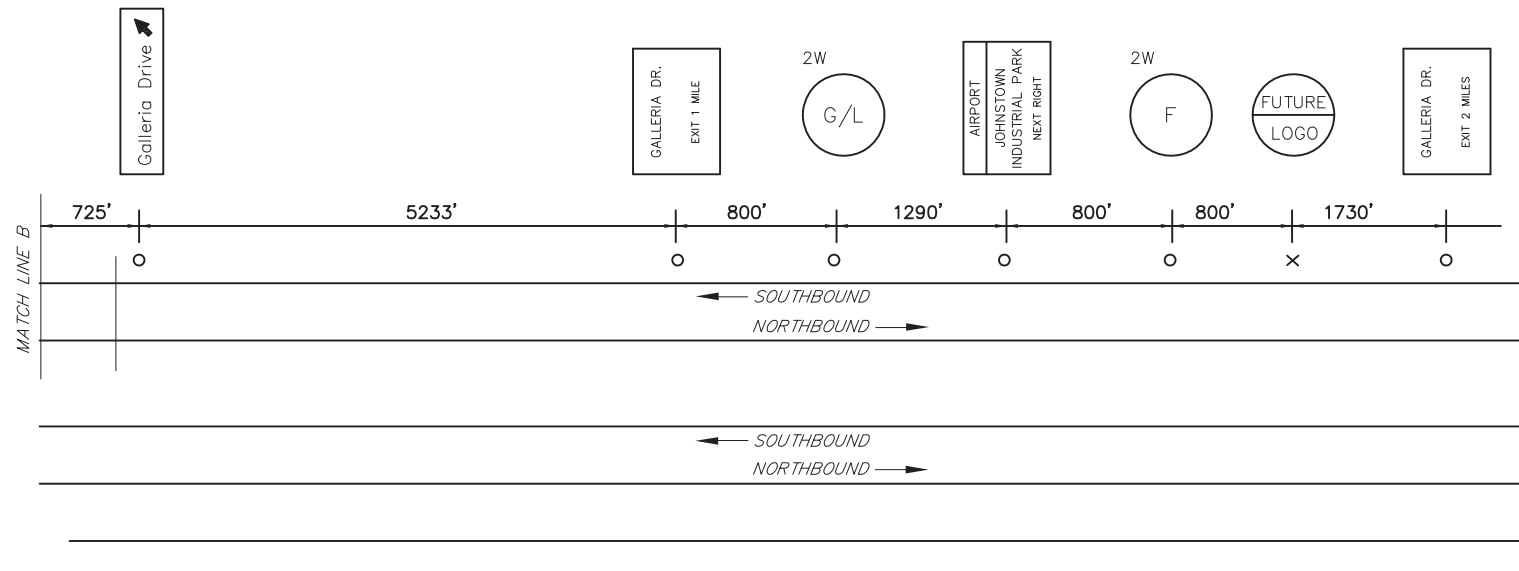

NB NOT ELIGIBLE - INSUFFICIENT SPACE

MAINLINE SCHEMATIC  
NOT TO SCALE

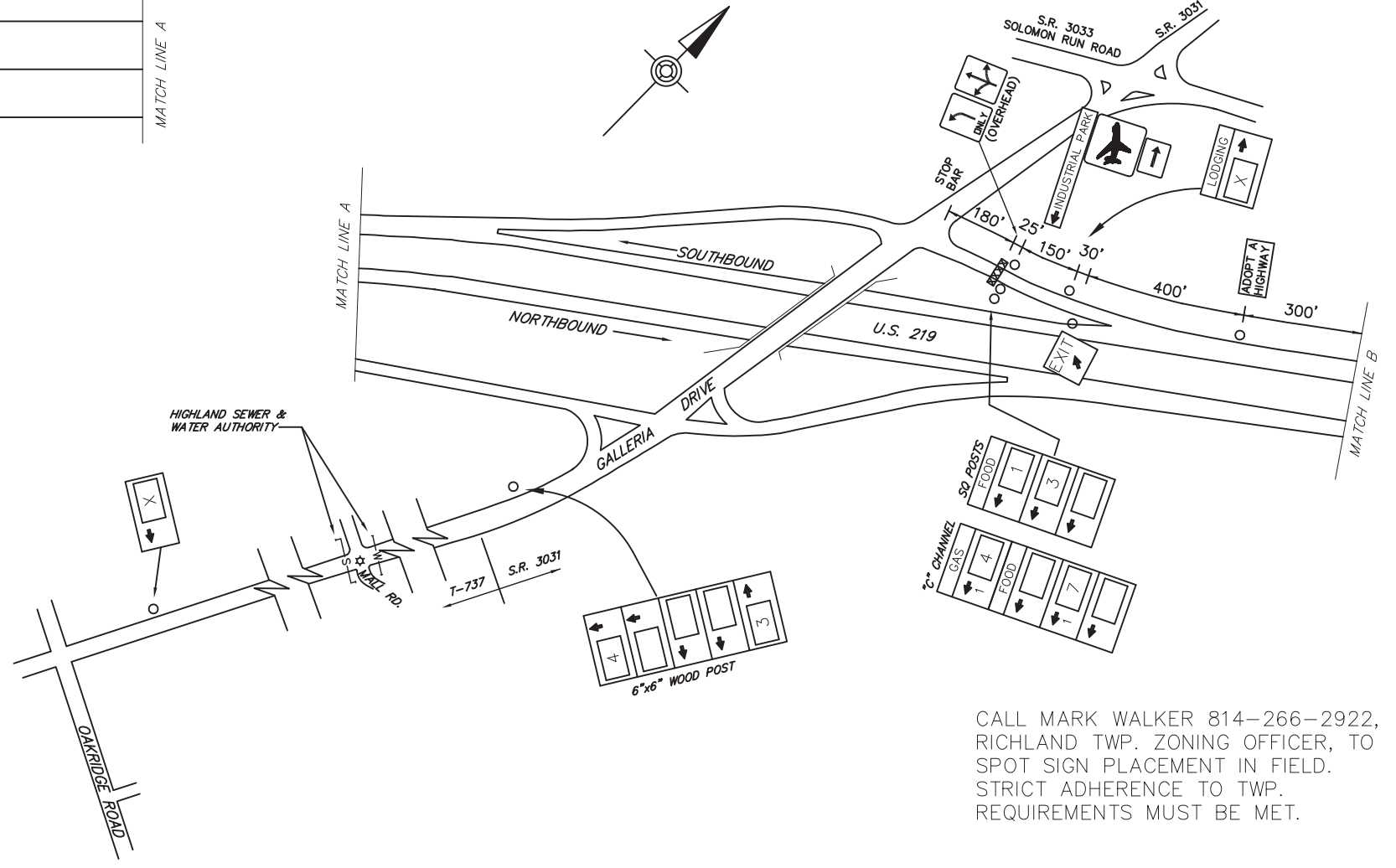

**LEGEND**  
2W - GUIDE RAIL

GALLERIA DRIVE SPECIFIC INFORMATION PANEL			
LEGEND	DIRECTION	BUSINESS	LOGO. NO.
FOOD	SB	McDONALD'S #13007	1
		PERKINS FAMILY RESTAURANT #3894	3
		APPLEBEE'S	7
GAS	SB	SHEETZ #227 (DIESEL)	4
LODGING	SB	X	X

**SB SIGNS**

12'HX19'W  
W14x30 A572  
3M TYPE III  
B650 - #2, #2

GAS - NEXT RIGHT

4		
---	--	--

LODGING - NEXT RIGHT

X		
---	--	--

10'HX19'W  
W12x26 A572  
3M TYPE III  
B650 - #2, #2

FOOD - NEXT RIGHT

1		3
	7	

SCHEMATIC PLAN  
NOT TO SCALE

CALL MARK WALKER 814-266-2922,  
RICHLAND TWP. ZONING OFFICER, TO  
SPOT SIGN PLACEMENT IN FIELD.  
STRICT ADHERENCE TO TWP.  
REQUIREMENTS MUST BE MET.

219  
SR 3031  
GALLERIA DRIVE

15' DATE: 06/25/2019 10:58:02 AM DRAWN: JAVIER/AMV/DES/AS-BUILD: BRAYAN/DES/PERM/DISTRICT: 09-CAMBRIA - 11-00-XX SHEET: 219-GALLERIA EXIT PLAN  
 DATE: 06/25/2019 10:58:02 AM