

DISTRICT	COUNTY	ROUTE	PROJECT	SHEET
2-0	CLINTON	US 220		
PINE CREEK TOWNSHIP & AVIS BORO REVISIONS				

SYMBOLS

- Existing Sign to Remain
- △ Existing Sign to be Removed
- ◻ Existing Sign Reset as Shown
- NEW SIGN
- × FUTURE SIGN
- ⊙ Existing Utility Pole

TABULATION OF QUANTITIES

ITEM	UNIT	QUANTITY
POST MOUNTED SIGNS, TYPE A, LOGO	SQ.FT.	
POST MOUNTED SIGNS, TYPE B, LOGO	SQ.FT.	
POST MOUNTED SIGNS, TYPE C, LOGO	SQ.FT.	
BREAKAWAY SYSTEMS	EACH	
* STEEL S OR W BEAM POSTS	LBS.	
LOGO SIGN MOUNTING	EACH	
REMOVAL OF POST MOUNTED MOTORIST SERVICE SIGNS, TYPES A & E	EACH	
REMOVAL OF POST MOUNTED MOTORIST SERVICE SIGNS, TYPES B, C & F	L.S.	

* APPROXIMATE QUANTITY FOR INFORMATION ONLY

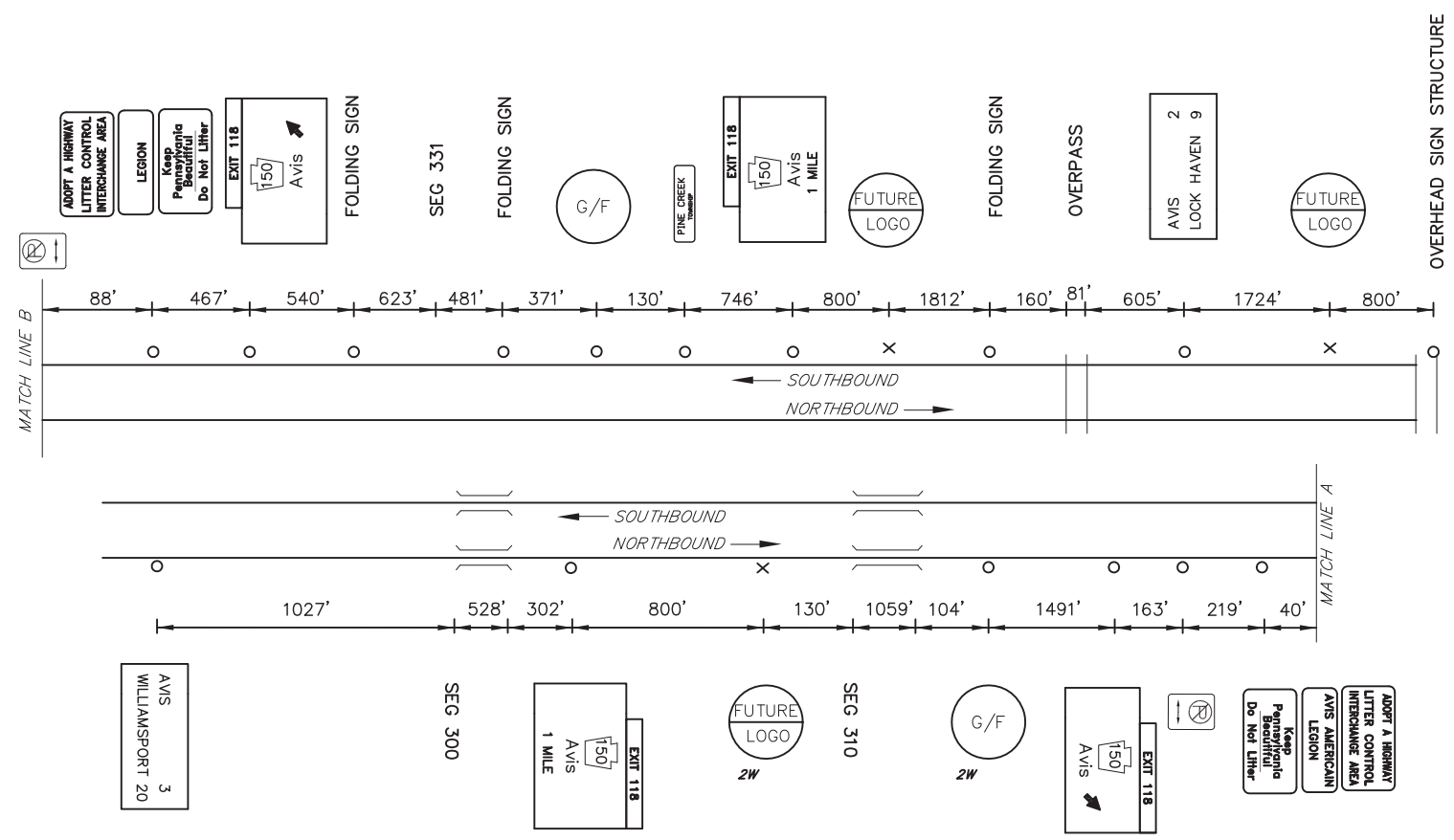

LEGEND
2W - GUIDE RAIL

EXIT 118 AVIS SPECIFIC INFORMATION PANEL

LEGEND	DIRECTION	BUSINESS	LOGO. NO.
GAS	NB/SB	MINI MART (DIESEL) (24HRS)	1
	NB/SB	SUNOCO (DIESEL) (24HRS)	3
FOOD	SB	AMBEST	4
		BURGER KING	2

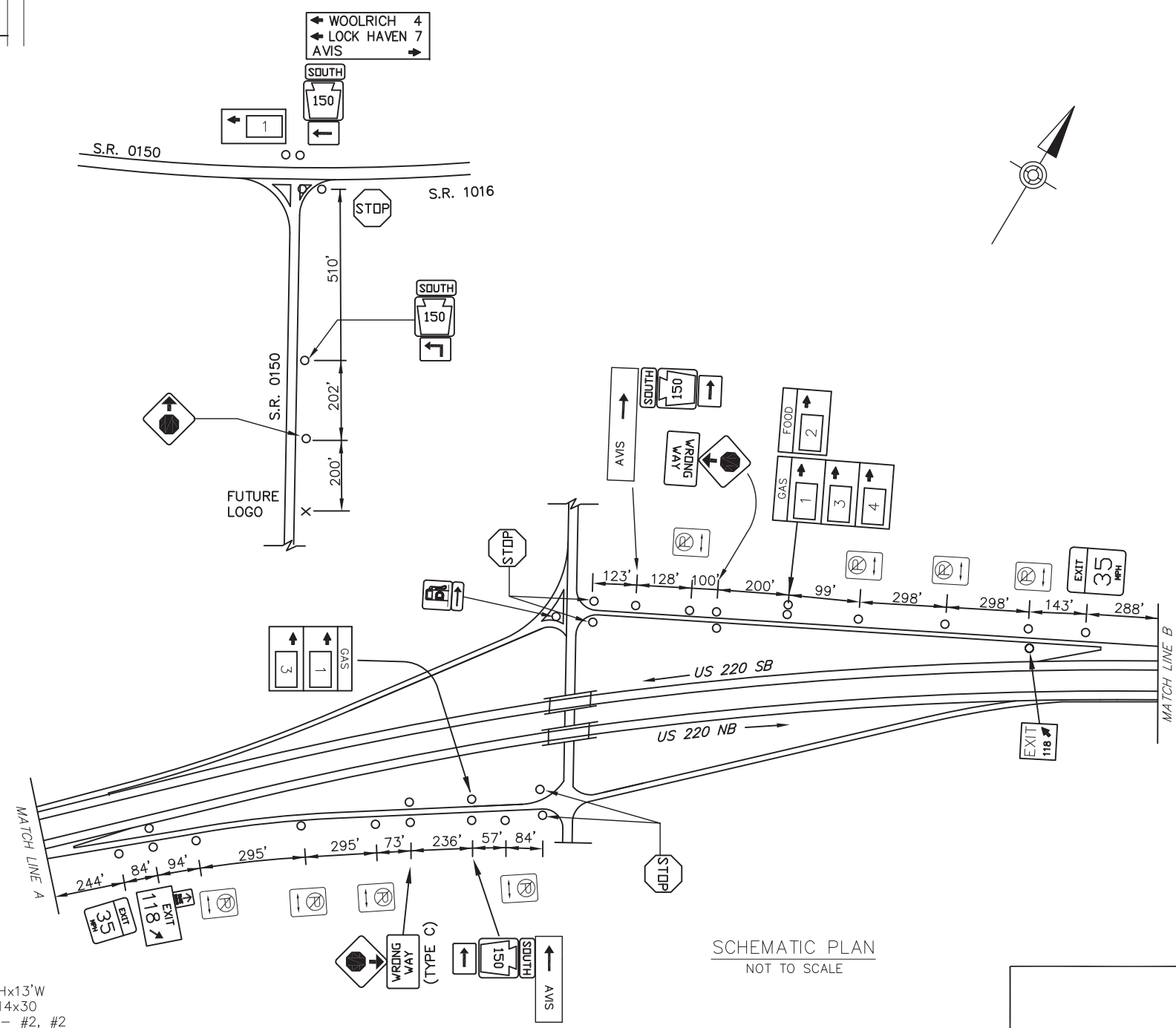
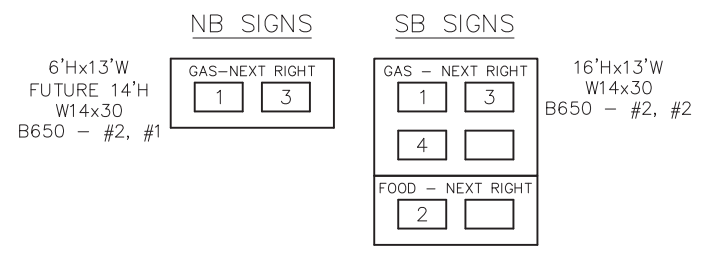

D:\BASE\DESIGN\2019\AVIS\AVIS-118\DRAWINGS\PERMITS - DISTRICT DECLINTEN - 1810-XX-SHFX-2019-AVIS-EXIT 118 PLAN August 27, 2019 10:56 AM