

DISTRICT	COUNTY	ROUTE	PROJECT	SHEET
5-0	MONROE	1-380		
BORO OF MOUNT POCONO				
COOLBAUGH & TOBYHANNA TOWNSHIPS				
REVISIONS				

TABULATION OF QUANTITIES		
ITEM	UNIT	QUANTITY
POST MOUNTED SIGNS, TYPE A, LOGO	SQ.FT.	
POST MOUNTED SIGNS, TYPE B, LOGO	SQ.FT.	
POST MOUNTED SIGNS, TYPE C, LOGO	SQ.FT.	
BREAKAWAY SYSTEMS	EACH	
* STEEL S OR W BEAM POSTS	LBS.	
LOGO SIGN MOUNTING	EACH	
FLAT SHEET PANEL REPLACEMENT	SQ.FT.	
EXTRUDED PANEL REPLACEMENT	SQ.FT.	
REMOVAL OF POST MOUNTED MOTORIST SERVICE SIGNS, TYPES B, C & F	L.S.	

* APPROXIMATE QUANTITY FOR INFORMATION ONLY

SYMBOLS	
○	Existing Sign to Remain
△	Existing Sign to be Removed
□	Existing Sign Reset as Shown
●	NEW SIGN
×	FUTURE SIGN
∅	Existing Utility Pole

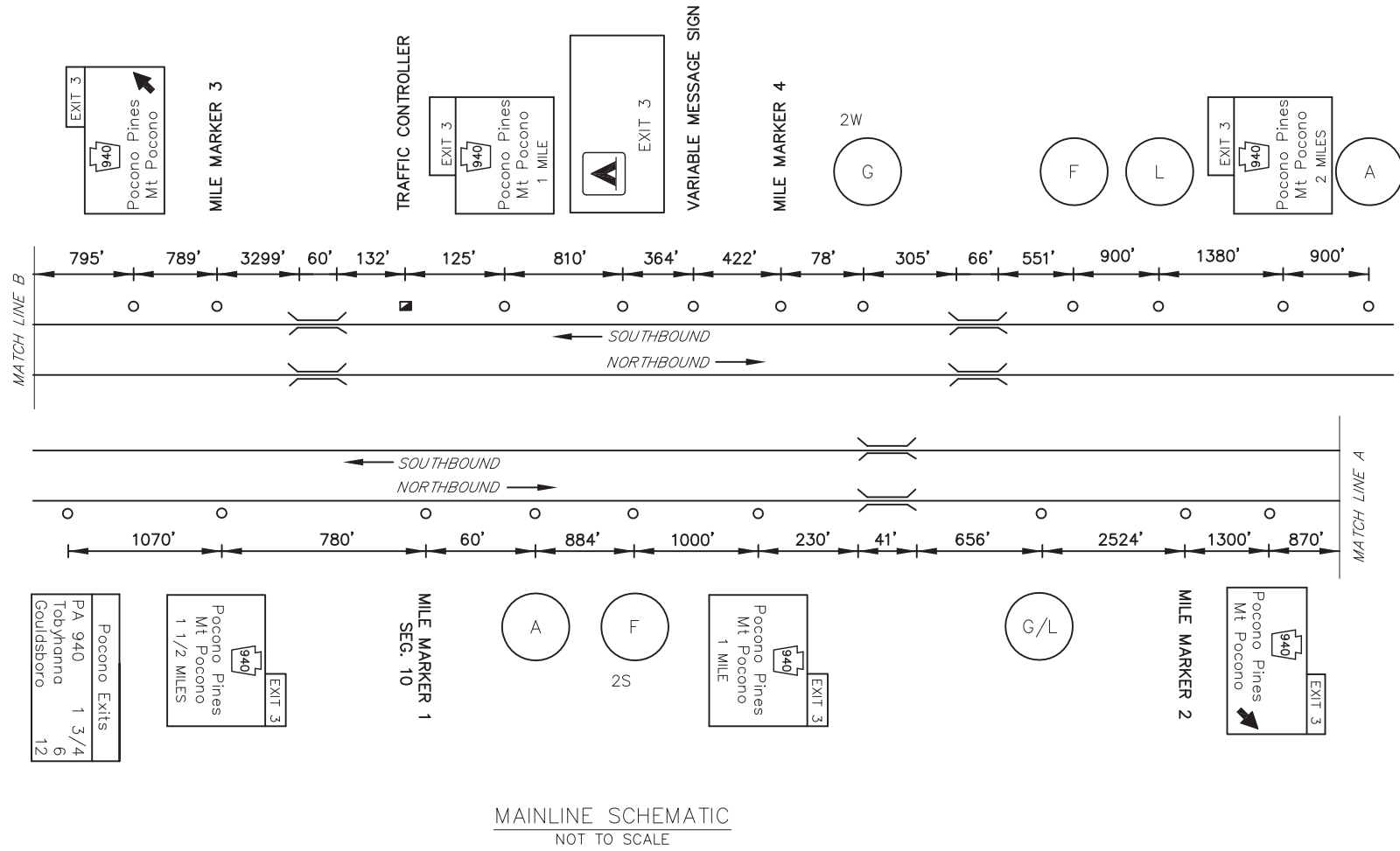

LEGEND

2S/2W - GUIDE RAIL

DO NOT CLOSE OR RESTRICT TRAVEL LANES BETWEEN 6:00 AM & 9:00 AM, AND BETWEEN 3:00 PM & 6:00 PM MONDAY THRU FRIDAY.

NO WORK PERMITTED ON POCONO RACEWAY EVENT DATES.

DO NOT WORK DURING HOLIDAY PERIODS.

EXIT 3 SPECIFIC INFORMATION PANEL			
LEGEND	DIRECTION	BUSINESS	LOGO. NO.
GAS	NB/SB		
FOOD	NB/SB	BURGER KING	3
		KFC	2
		McDONALD'S (24 Hours)	5
		WENDY'S	1
		PERKINS FAMILY RESTAURANT-BAKERY	8
		SUBWAY	4
LODGING	NB/SB	HOTEL MOUNT POCONO	7
		COMFORT INN & SUITES	9
		THE INN AT POCONO MANOR	12
ATTRACTION	NB/SB	MOUNT AIRY CASINO - RESORT	10
		KALAHARI RESORTS	13

<p>NB SIGNS</p> <p>12'Hx19'W FUTURE 14'H W12x26 A572 3M TYPE III B650 - #2, #2</p> <p>14'Hx13'W W10x26 A572 3M TYPE III B650 - #2, #1</p> <p>08/8/2019 FIELD INSPECTION NOTED EXPOSED REBAR ON BOTH FOUNDATIONS</p> <p>6'Hx13'W FUTURE 16'H W10x26 A572 TYPE IX LEGEND TYPE III BACKGROUND B650 - #1, #2</p>	<p>SB SIGNS</p> <p>6'Hx13'W 13.5'H TOP SECTION FUTURE 12'H W12x26 A572 3M TYPE III B650 - #1 #1</p> <p>14'Hx13'W 16'H TOP SECTION FUTURE 16'H W14x30 A572 3M TYPE III B650 - #2, #1</p> <p>10'Hx13'W FUTURE 16'H W18x40 A572 3M TYPE III B650 - #2, #2</p> <p>6'H x 13'W FUTURE 16'H W14x30 A572 TYPE IX LEGEND TYPE III BACKGROUND B650 - #1 #1</p>
---	---

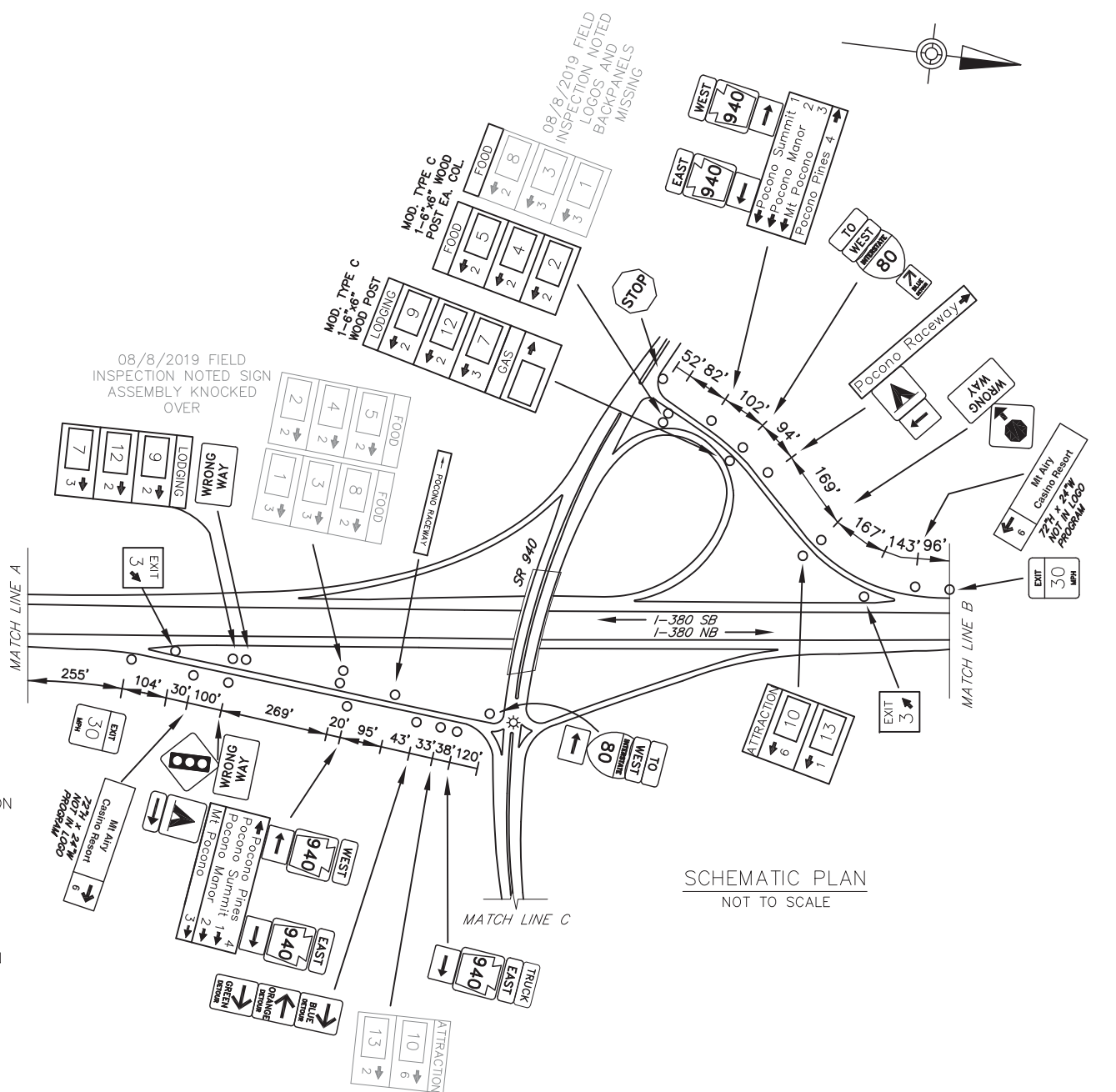

SCHMATIC PLAN
NOT TO SCALE

INTERSTATE 380

MT POCONO
EXIT 3

SHEET 1 OF 2 THIS EXIT

D:\PROJECTS\2019\1-380\1-380-EXIT 3 PLAN
 12/11/2019 11:00 AM
 DISTRICT 05/06/2019
 4510-XX-001-1-380-EXIT 3 PLAN

