

DISTRICT	COUNTY	ROUTE	PROJECT	SHEET
5-0	MONROE	I-80		
EAST STROUDSBURG & STROUDSBURG BOROS & SMITHFIELD TWP. REVISIONS				

TABULATION OF QUANTITIES		
ITEM	UNIT	QUANTITY
POST MOUNTED SIGNS, TYPE A, LOGO	SQ.FT.	
POST MOUNTED SIGNS, TYPE B, LOGO	SQ.FT.	
RESET OF POST MOUNTED SIGN, TYPE A	EACH	
BREAKAWAY SYSTEMS	EACH	
* STEEL S OR W BEAM POSTS	LBS.	
LOGO SIGN MOUNTING	EACH	
REMOVAL OF POST MOUNTED MOTORIST SERVICE SIGNS, TYPES A & E	EACH	
REMOVAL OF POST MOUNTED MOTORIST SERVICE SIGNS, TYPES B, C & F	L.S.	

\* APPROXIMATE QUANTITY FOR INFORMATION ONLY

SYMBOLS	
○	Existing Sign to Remain
△	Existing Sign to be Removed
◻	Existing Sign Reset as Shown
●	NEW SIGN
×	FUTURE SIGN
⊗	Existing Utility Pole

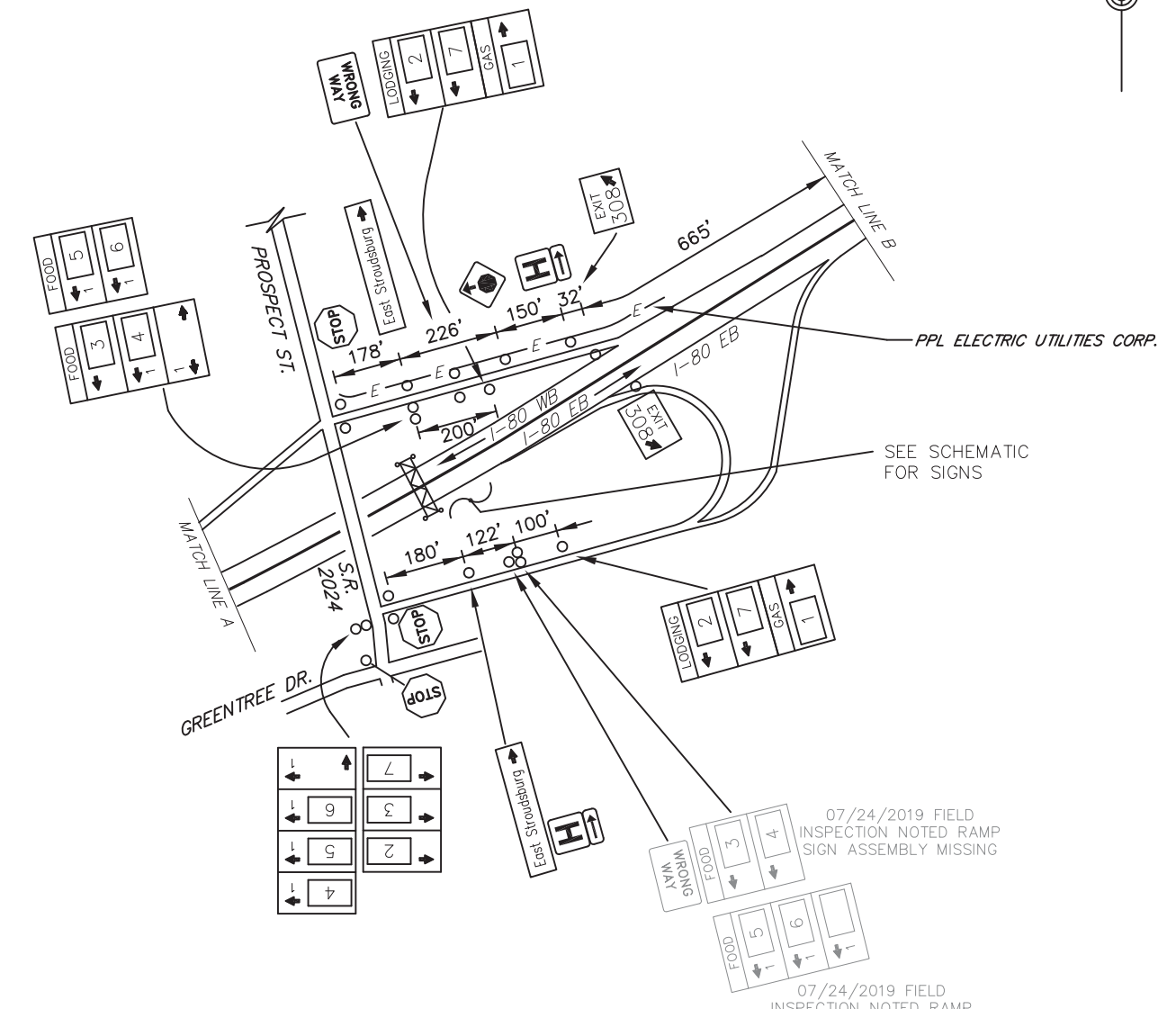
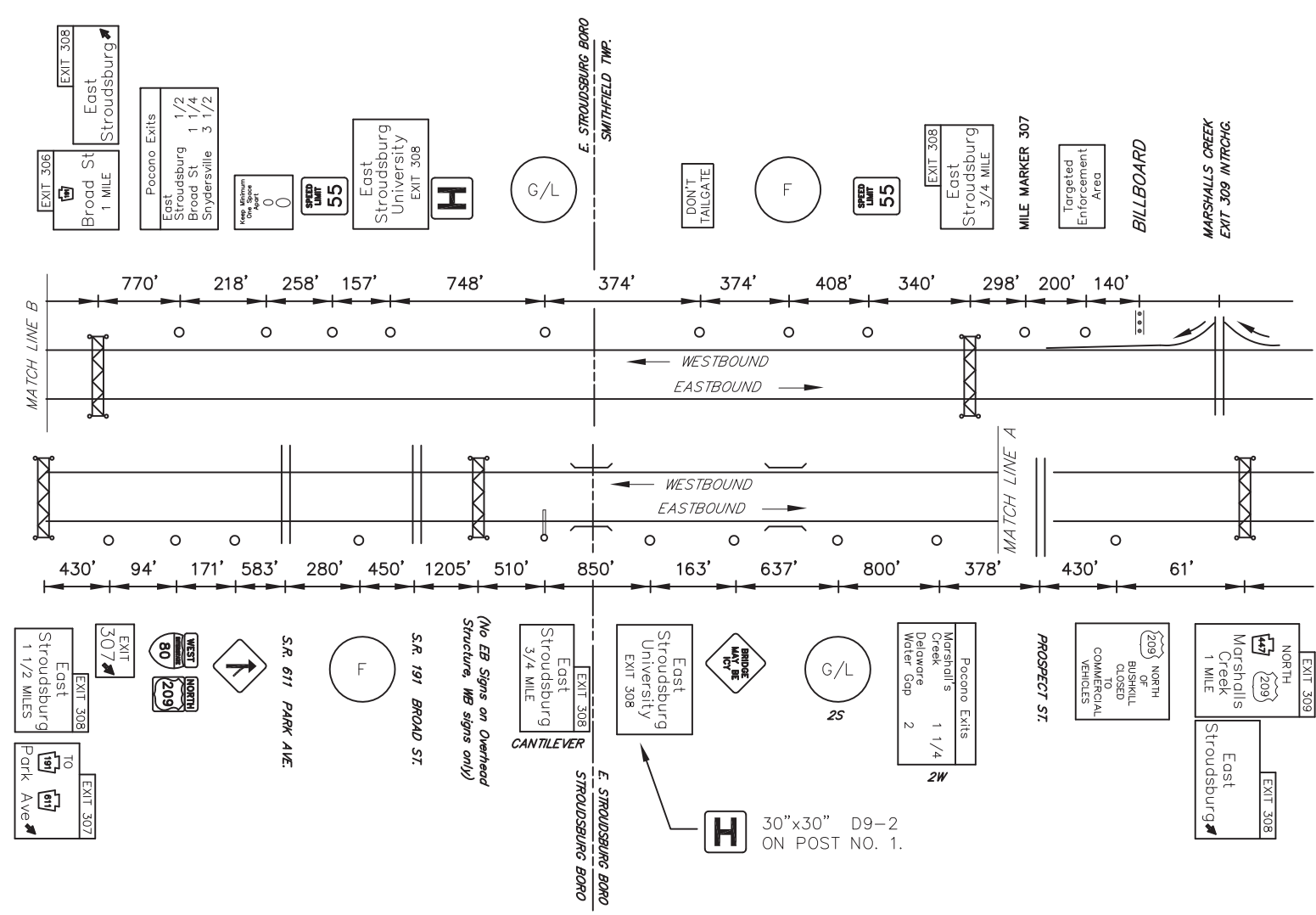

**LEGEND**  
2S/2W - GUIDE RAIL

EXIT 308 SPECIFIC INFORMATION PANEL			
LEGEND	DIRECTION	BUSINESS	LOGO. NO.
FOOD	EB/WB	ROASTED TOMATO DINER	3
		ARBY'S	4
		FRIENDLY'S	5
		BURGER KING	6
GAS	EB/WB	EXXON (DIESEL/24 HOURS)	1
LODGING	EB/WB	QUALITY INN	2
		SUPER 8	7

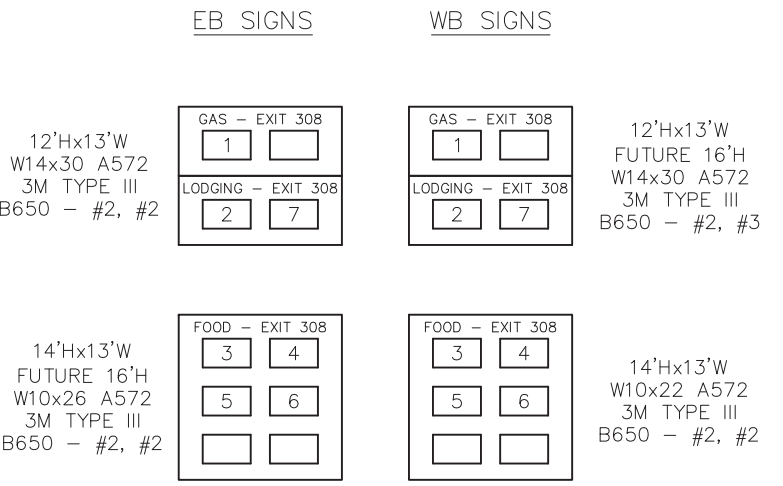

D:\BASE FILES\PROJECTS\AN\W\USE\AS-BUILD\DRAWINGS\PERMITS-DISTRICT\5-MONROE - 4510-XX-SHFX-18E-EXIT 308 PLAN August 22, 2019 10:51 AM

