

DISTRICT	COUNTY	ROUTE	PROJECT	SHEET
8-0	FRANKLIN	I-81		
ANTRIM AND GUILFORD TOWNSHIPS				
REVISIONS				

TABULATION OF QUANTITIES		
ITEM	UNIT	QUANTITY
POST MOUNTED SIGNS, TYPE A, LOGO	SQ.FT.	
POST MOUNTED SIGNS, TYPE A, LOGO (MODIFIED)	SQ.FT.	-
POST MOUNTED SIGNS, TYPE C, LOGO	SQ.FT.	
BREAKAWAY SYSTEMS	EACH	
* STEEL S OR W BEAM POSTS	LBS.	
LOGO SIGN MOUNTING	EACH	-
LOGO SIGN MOUNTING, RESET	EACH	
REMOVAL OF POST MOUNTED MOTORIST SERVICE SIGNS, TYPES A & E	EACH	
REMOVAL OF POST MOUNTED MOTORIST SERVICE SIGNS, TYPES B, C & F	L.S.	

* APPROXIMATE QUANTITY FOR INFORMATION ONLY

SYMBOLS	
○	Existing Sign to Remain
△	Existing Sign to be Removed
□	Existing Sign Reset as Shown
●	NEW SIGN
×	FUTURE SIGN
⊗	Existing Utility Pole

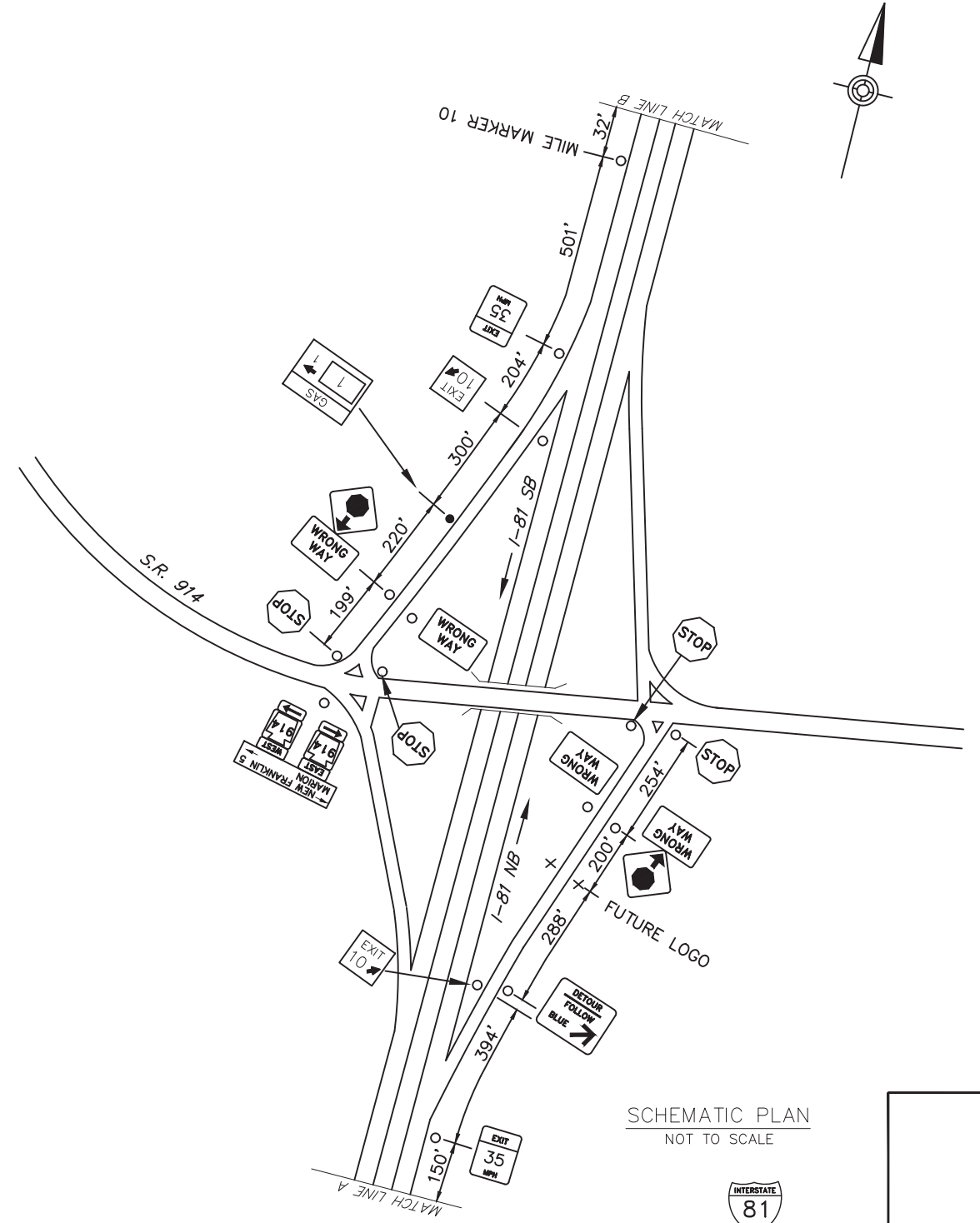
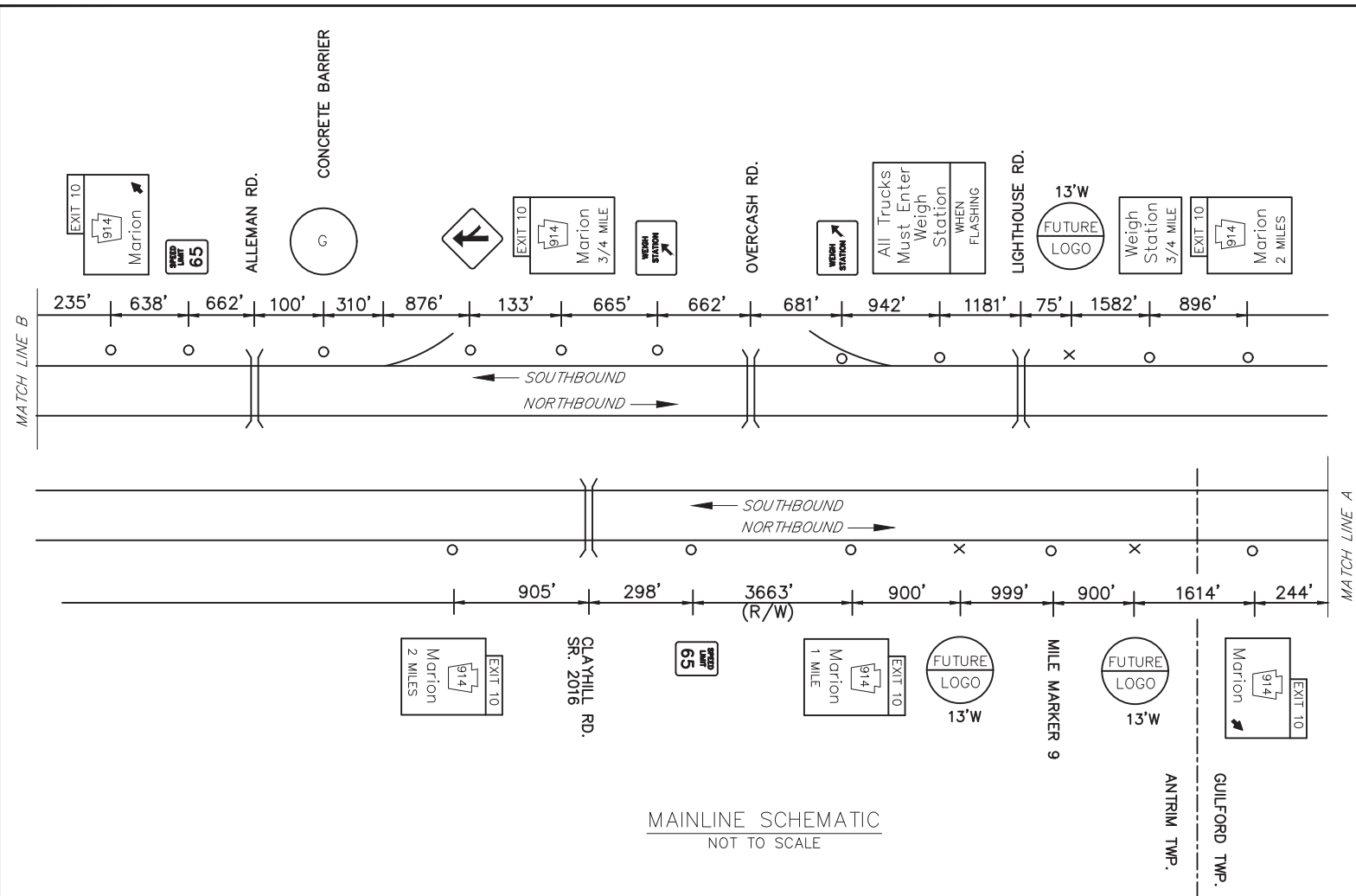

FREEWAY LANE CLOSURES & RESTRICTIONS ONLY PERMITTED BETWEEN 9:00 PM AND 6:00 AM MONDAY THRU FRIDAY.
 WORK ALONG FREEWAY PERMITTED BETWEEN 9:00 AM AND 2:30 PM, UNLESS OTHERWISE APPROVED BY ENGINEERING DISTRICT.
 DO NOT WORK DURING HOLIDAY PERIODS.
 IF APPLICABLE, REINSTALL GUIDERAIL AT END OF EACH DAY.

EXIT 10 SPECIFIC INFORMATION PANEL			
LEGEND	DIRECTION	BUSINESS	LOGO. NO.
GAS	SB	CEBCO (24 HOURS/DIESEL)	1

NB SIGNS

SB SIGNS



6'Hx13'W
 FUTURE 16"H
 W14x30
 AVERY TYPE IV
 B650 - #2, #2



D:\DATA\PROJECTS\2014\ANTRIM\AS-BUILD\DRAWINGS\PERMITS\DISTRICT\88\FRANKLIN - 88-UP-XX-SHT\TAC-SB-EXIT 10 PLAN
 September 24/2019 3:28 PM