

DISTRICT	COUNTY	ROUTE	PROJECT	SHEET
4-0	PIKE	I-84		
PA: WEST FALL TOWNSHIP & MATAMORAS BOROUGH				
NY: ORANGE CO., TOWN OF DEER PARK				
REVISIONS				

TABULATION OF QUANTITIES		
ITEM	UNIT	QUANTITY
EXTRUDED PANEL REPLACEMENT	SQ.FT.	
POST MOUNTED SIGNS, TYPE B, LOGO	SQ.FT.	
POST MOUNTED SIGNS, TYPE C, LOGO	SQ.FT.	
BREAKAWAY SYSTEMS	EACH	
* STEEL S OR W BEAM POSTS	LBS.	
LOGO SIGN MOUNTING	EACH	
REMOVAL OF POST MOUNTED MOTORIST SERVICE SIGNS, TYPES A & E	EACH	
REMOVAL OF POST MOUNTED MOTORIST SERVICE SIGNS, TYPES B, C & F	L.S.	

SYMBOLS

- Existing Sign to Remain
- △ Existing Sign to be Removed
- ◻ Existing Sign Reset as Shown
- NEW SIGN
- × FUTURE SIGN
- ∅ Existing Utility Pole

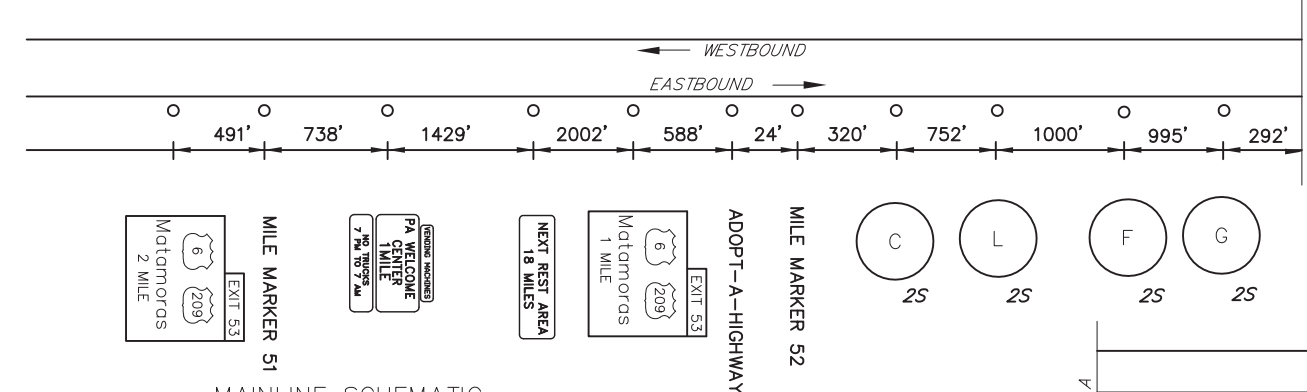
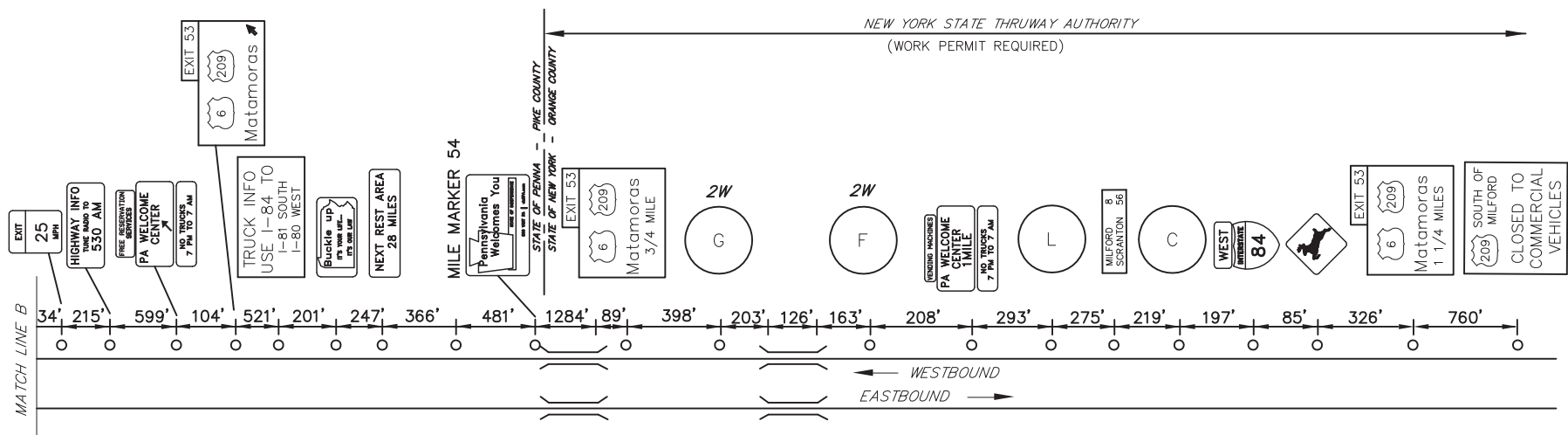

MAINLINE SCHEMATIC
NOT TO SCALE

08/29/2019 FIELD INSPECTION NOTED SIGN ASSEMBLY KNOCKED OVER

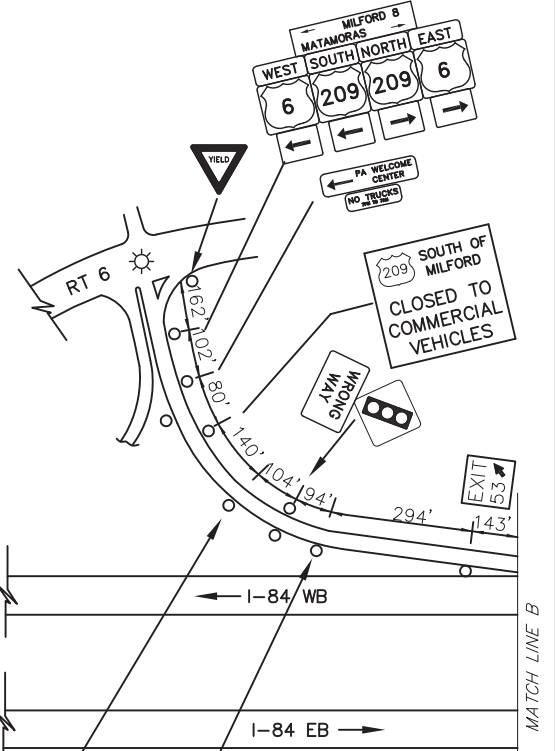
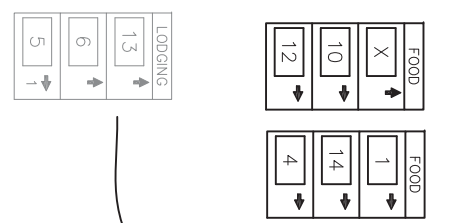

SCHEMATIC PLAN
NOT TO SCALE

LEGEND
2S/2W - GUIDE RAIL

EXIT 53 SPECIFIC INFORMATION PANEL			
LEGEND	DIRECTION	BUSINESS	LOGO. NO.
GAS	EB/WB	SHELL	2
FOOD	EB/WB	TACO BELL	1
		MCDONALD'S	4
		WENDY'S	10
		PERKIN'S FAMILY RESTAURANT	12
		ROY ROGERS	14
LODGING	EB/WB	SCOTTISH INNS	5
		HAMPTON INN	13
		BEST WESTERN	6
CAMPING	EB/WB	RIVER BEACH CAMPSITES	8

EB SIGNS

10'Hx16'W
48"W LOGO
W10x26
B650 - #1, #1
SPLIT BASE
RETROFIT

10'Hx19'W
W10x22 A572
3M TYPE III
B650 - #2, #1

07/24/2019 FIELD INSPECTION NOTED BEST WESTERN (6) LOGO MISSING

10'Hx13'W
FUTURE 14'H
W10x26
B650 - #2, #1
SPLIT BASE
RETROFIT

10'Hx13'W
FUTURE 12'H
W8x21
B525 - #1, #1

WB SIGNS

10'Hx16'W
48"W LOGO
W10x22
NO BRACKETS

10'Hx19'W
W12x26 A572
3M TYPE III
B650 - #2, #1

10'Hx13'W
W8x10
NO BRACKETS

10'Hx13'W
W8x10
NO BRACKETS
FLAT SHEET ALUM.
BACKPANEL WITH
STIFFENERS

D:\BIDDING\2019\04\PA\WEST FALL TOWNSHIP & MATAMORAS BOROUGH\DRAWINGS\PERMITS\DISTRICT 4\PA\PA - SIGNAGE - SHIFTS-I-84-EXIT 53 PLAN
 September 20/2019 11:45 AM

RT 6/RT 209/MATAMORAS
 EXIT 53