

DISTRICT	COUNTY	ROUTE	PROJECT	SHEET
5-0	NORTHAMPTON	PA 33	-	-
LOWER NAZARETH & PALMER TOWNSHIPS				
REVISIONS				

TABULATION OF QUANTITIES		
ITEM	UNIT	QUANTITY
* STEEL S OR W BEAM POSTS	LBS.	-
BREAKAWAY SYSTEMS	EACH	-
POST MOUNTED SIGNS, TYPE A, LOGO	SQ.FT.	-
POST MOUNTED SIGNS, TYPE B, LOGO	SQ.FT.	-
POST MOUNTED SIGNS, TYPE C, LOGO	SQ.FT.	-
LOGO SIGN MOUNTING	EACH	-

\* APPROXIMATE QUANTITY FOR INFORMATION ONLY

SYMBOLS	
○	Existing Sign to Remain
△	Existing Sign to be Removed
◻	Existing Sign Reset as Shown
●	NEW SIGN
×	FUTURE SIGN
⊙	Existing Utility Pole

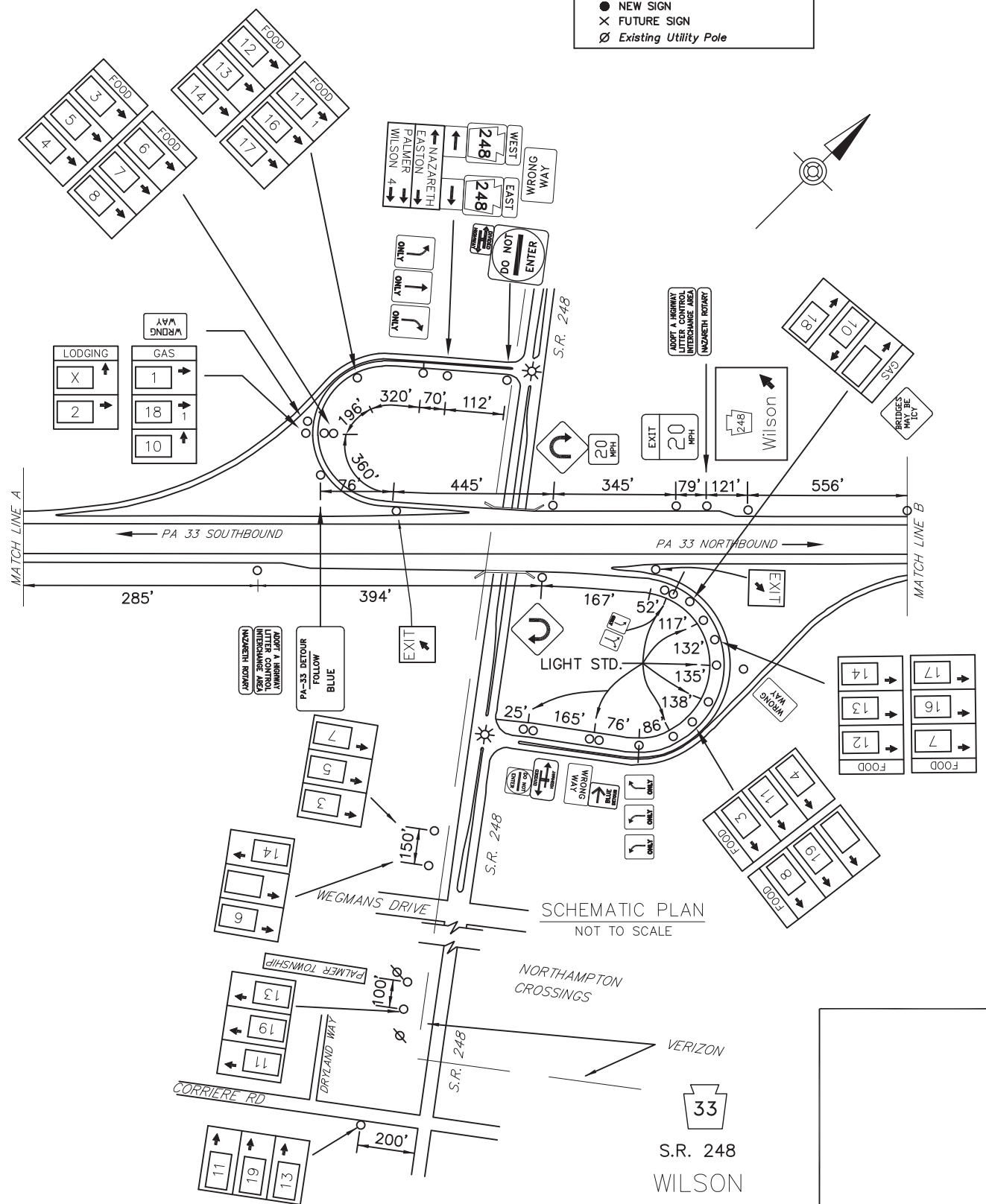
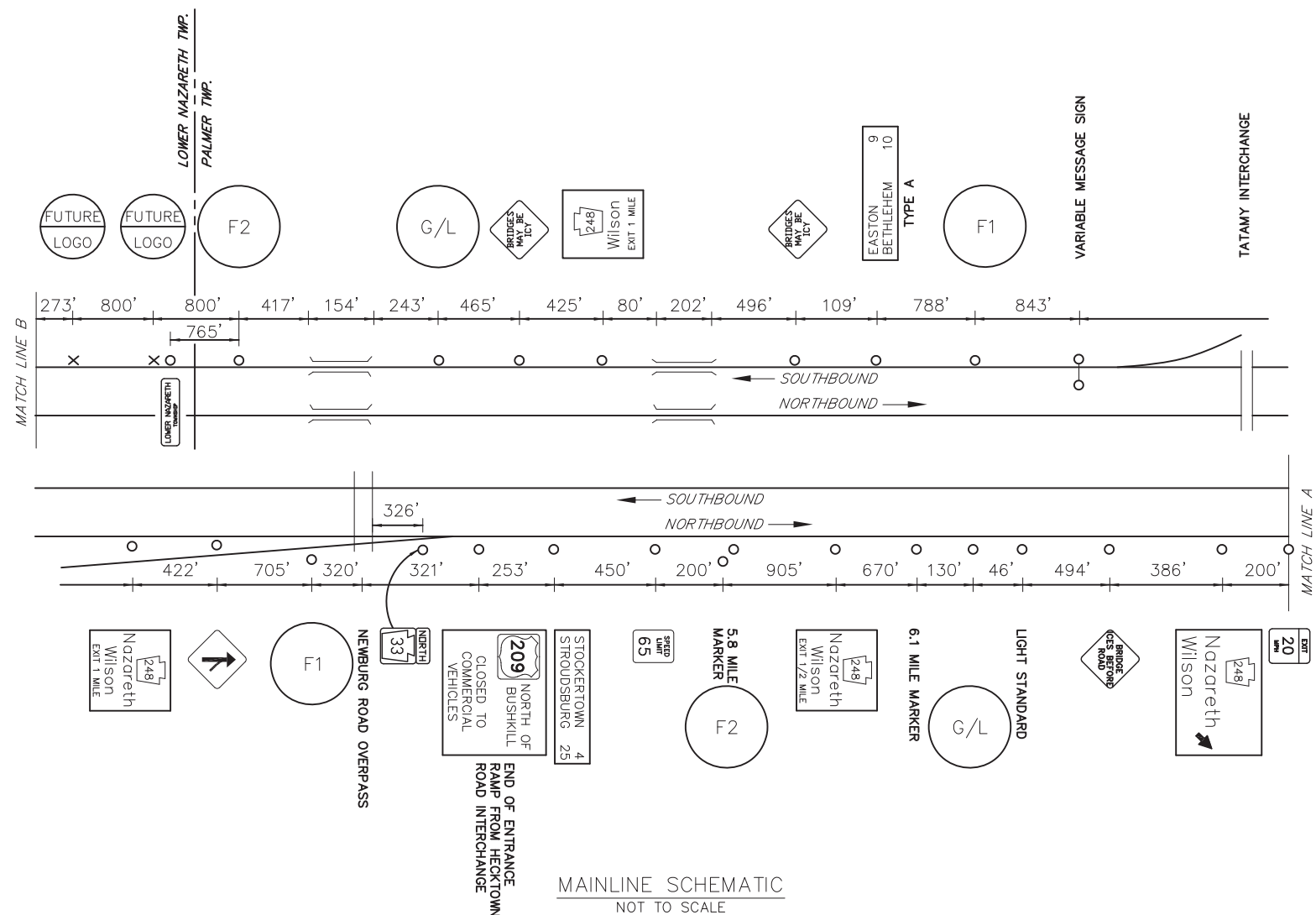

DO NOT CLOSE OR RESTRICT TRAVEL LANES DURING RUSH HOUR. WORK ALONG FREEWAY PERMITTED BETWEEN 9:00 AM AND 2:30 PM, UNLESS OTHERWISE APPROVED BY ENGINEERING DISTRICT. DO NOT WORK DURING HOLIDAY. PERIODS IF APPLICABLE, REINSTALL GUIDERAIL AT END OF EACH DAY.

EXIT 33/WILSON SPECIFIC INFORMATION PANEL			
LEGEND	DIRECTION	BUSINESS	LOGO NO.
GAS	NB/SB	SUNOCO (DIESEL)	1
		WAWA (24 HRS/DIESEL)	10
		SHEETZ (DIESEL)	18
FOOD	NB/SB	RED ROBIN	3
		APPLEBEE'S	4
		STARBUCKS COFFEE	7
		McDONALD'S	8
		JERSEY MIKES	11
		BURGER KING	12
		CHICK-FIL-A (CLOSED SUNDAY)	13
		FIVE GUYS	14
		DINER 248	16
		PANERA BREAD	17
LODGING	NB/SB	LONGHORN STEAKHOUSE	19
		SUBWAY	5
LODGING	SB	ARBY'S	6

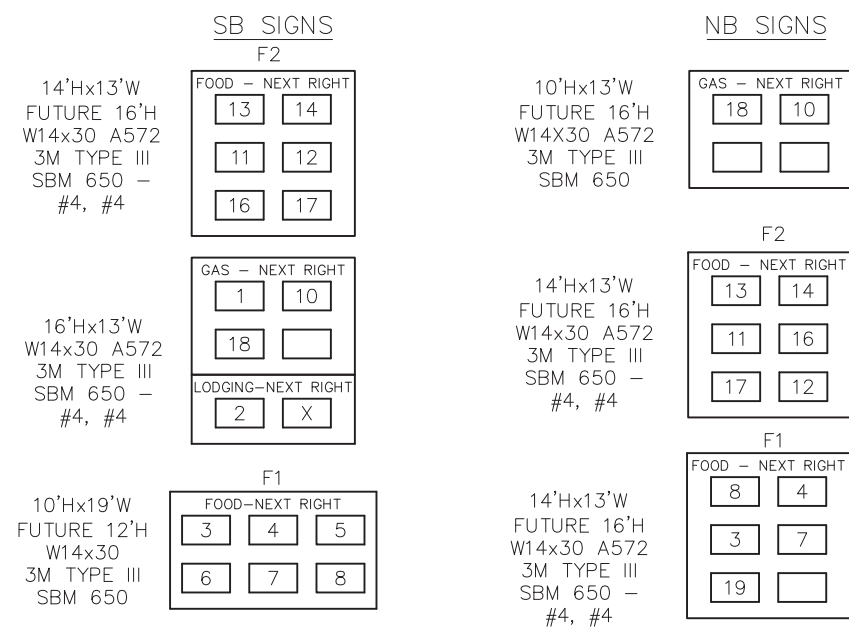

\PROJECTS\PA33\PROJECTS\2015\2015-05-15\PA33-03-EXIT WILSON PLAN  
 15/05/2015 10:30 AM  
 DISTRICT: 05-NORTHAMPTON - 4810-D-XX-SHFX-03-EXIT WILSON PLAN