

DISTRICT	COUNTY	ROUTE	PROJECT	SHEET
1-0	MERCER	1-79	SPRINGFIELD TOWNSHIP REVISIONS	

- SYMBOLS**
- Existing Sign to Remain
  - △ Existing Sign to be Removed
  - Existing Sign Reset as Shown
  - NEW SIGN
  - × FUTURE SIGN
  - ⊗ Existing Utility Pole

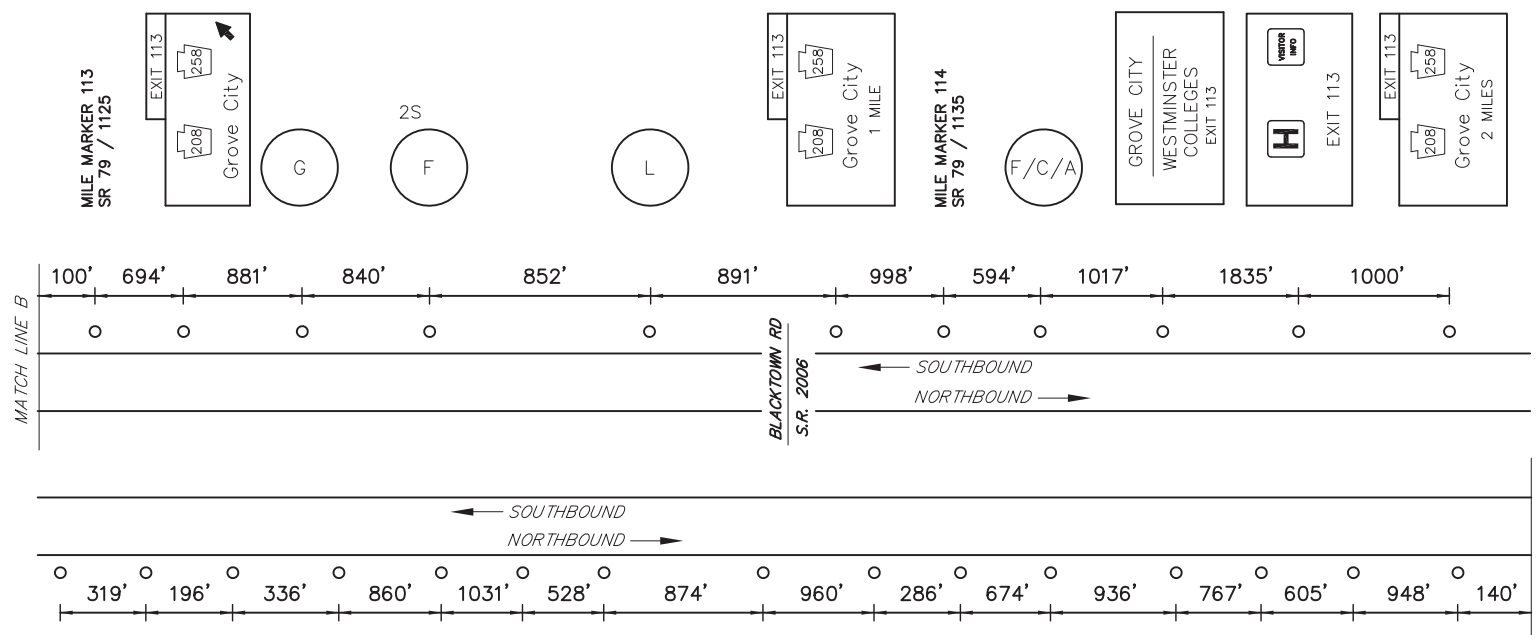

MAINLINE SCHEMATIC  
NOT TO SCALE

**LEGEND**

2S - GUIDE RAIL

DO NOT CLOSE OR RESTRICT TRAVEL LANES BETWEEN 7:00 AM FRIDAY AND 7:00 AM MONDAY. RE-OPEN CLOSED LANES IF SIGNIFICANT TRAFFIC CONGESTION IS OBSERVED. DO NOT WORK DURING HOLIDAY PERIODS.

EXIT 113 SPECIFIC INFORMATION PANEL			
LEGEND	DIRECTION	BUSINESS	LOGO NO.
FOOD	NB/SB	McDONALD'S	2
		EAT N' PARK	19
		SUBWAY	4
		HOSS'S FAMILY STEAK & SEA	12
		TACO BELL	22
GAS	NB/SB	WENDY'S	14
		PRIMANTI BROS.	18
		COMPADRE'S MEXICAN RESTAURANT	21
		KWIK FILL (DIESEL)	5
		MARATHON (24 Hours)	8
LODGING	NB/SB	COUNTRY FAIR CITGO (DIESEL)	11
		SHEETZ (DIESEL)	17
		BEST WESTERN	6
		COMFORT INN	9
		HOLIDAY INN EXPRESS	16
CAMPING	NB/SB	HAMPTON INN & SUITES	15
		CANDLEWOOD SUITES	20
		KOA KAMPGROUND	7
ATTRACTION	NB/SB	GROVE CITY PREMIUM OUTLETS	1
		KEYSTONE SAFARI	22

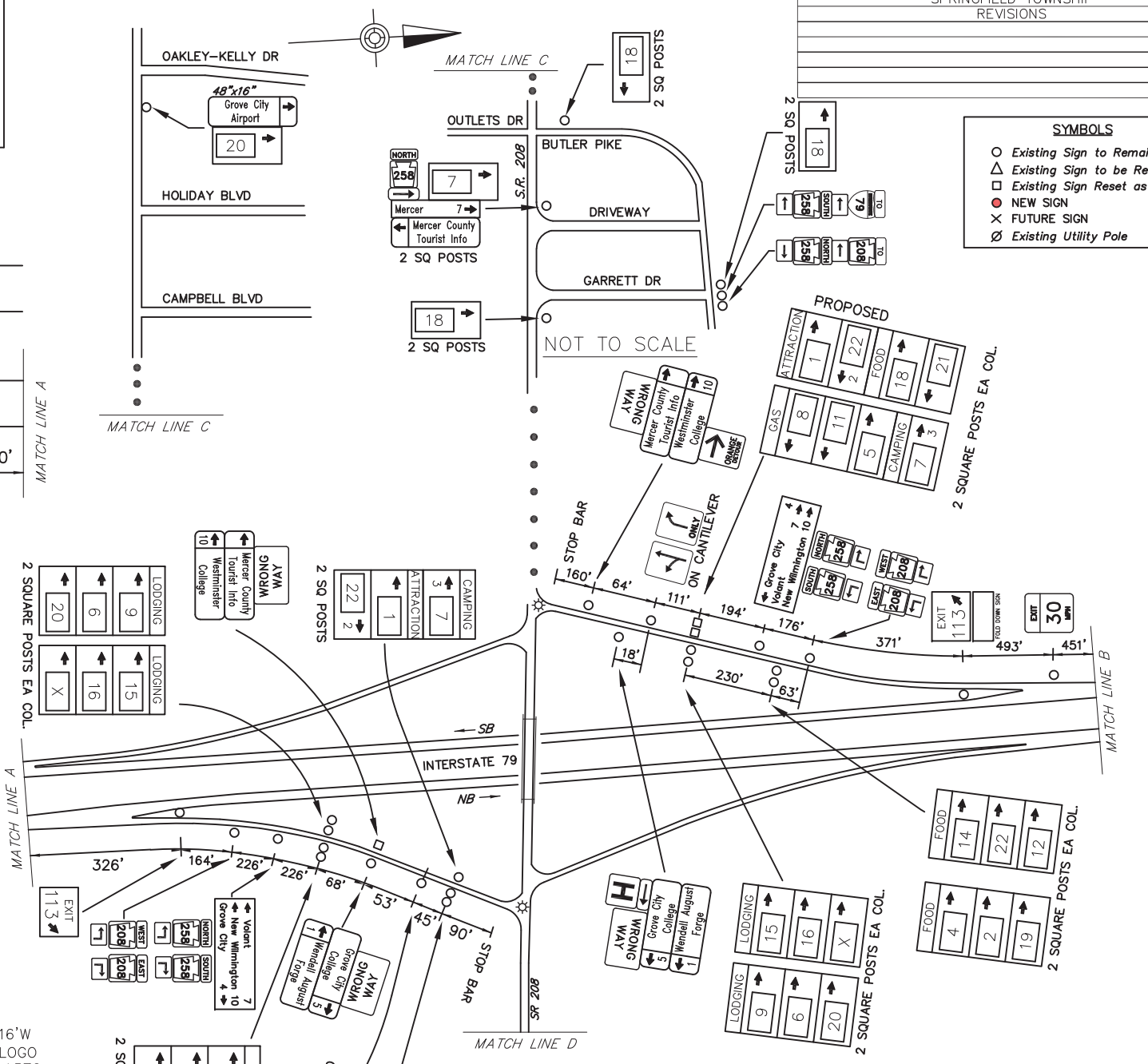
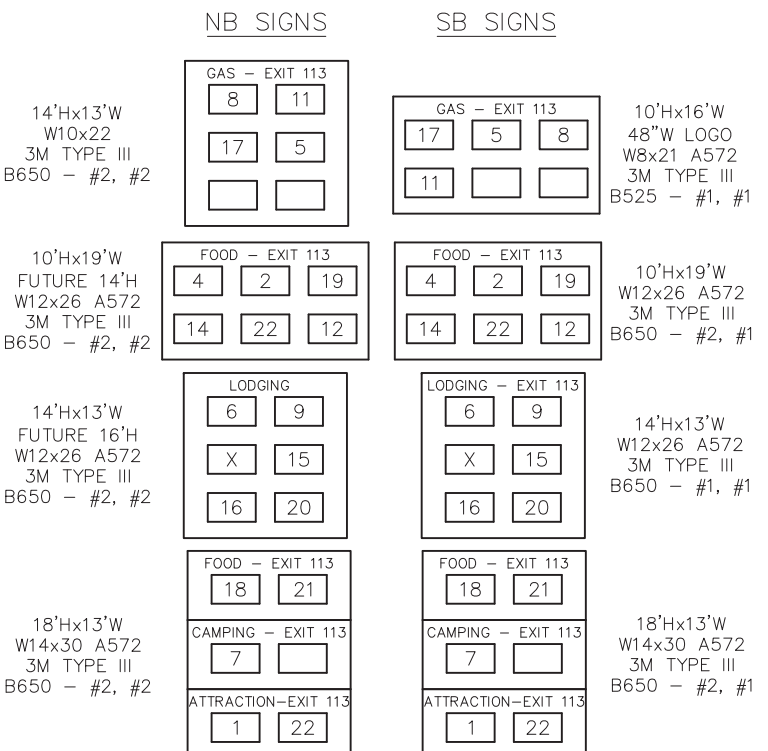

SCHEMATIC PLAN  
NOT TO SCALE

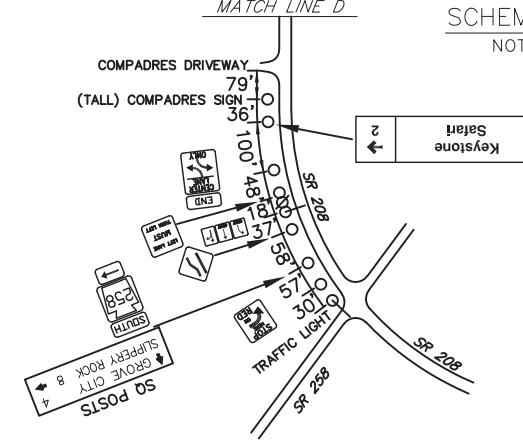

INTERSTATE 79  
GROVE CITY  
EXIT 113

DATE: 04/24/2014 10:54 AM PROJECT: 2013.005.000 SUBJECT: 2013.005.000.000 DISTRICT: 01/MERCER - BUILT DRAWINGS/PENNER DISTRICT: 01/MERCER - 45/010-KK SHIT XX 1-79-EXIT 113 PLAN NO: 22/2500 2401 PM