

DISTRICT	COUNTY	ROUTE	PROJECT	SHEET
3-0	COLUMBIA	I-80		
PLEASANT & SCOTT TOWNSHIPS				
REVISIONS				

TABULATION OF QUANTITIES		
ITEM	UNIT	QUANTITY
POST MOUNTED SIGNS, TYPE A, LOGO	SQ.FT.	
POST MOUNTED SIGNS, TYPE B, LOGO	SQ.FT.	
POST MOUNTED SIGNS, TYPE C, LOGO	SQ.FT.	
BREAKAWAY SYSTEMS	EACH	
* STEEL S OR W BEAM POSTS	LBS.	
LOGO SIGN MOUNTING	EACH	
FLAT SHEET PANEL REPLACEMENT	SQ.FT.	
EXTRUDED PANEL REPLACEMENT	SQ.FT.	
REMOVAL OF POST MOUNTED MOTORIST SERVICE SIGNS, TYPES B, C & F	L.S.	

**SYMBOLS**

- Existing Sign to Remain
- △ Existing Sign to be Removed
- Existing Sign Reset as Shown
- NEW SIGN
- × FUTURE SIGN

\* APPROXIMATE QUANTITY FOR INFORMATION ONLY

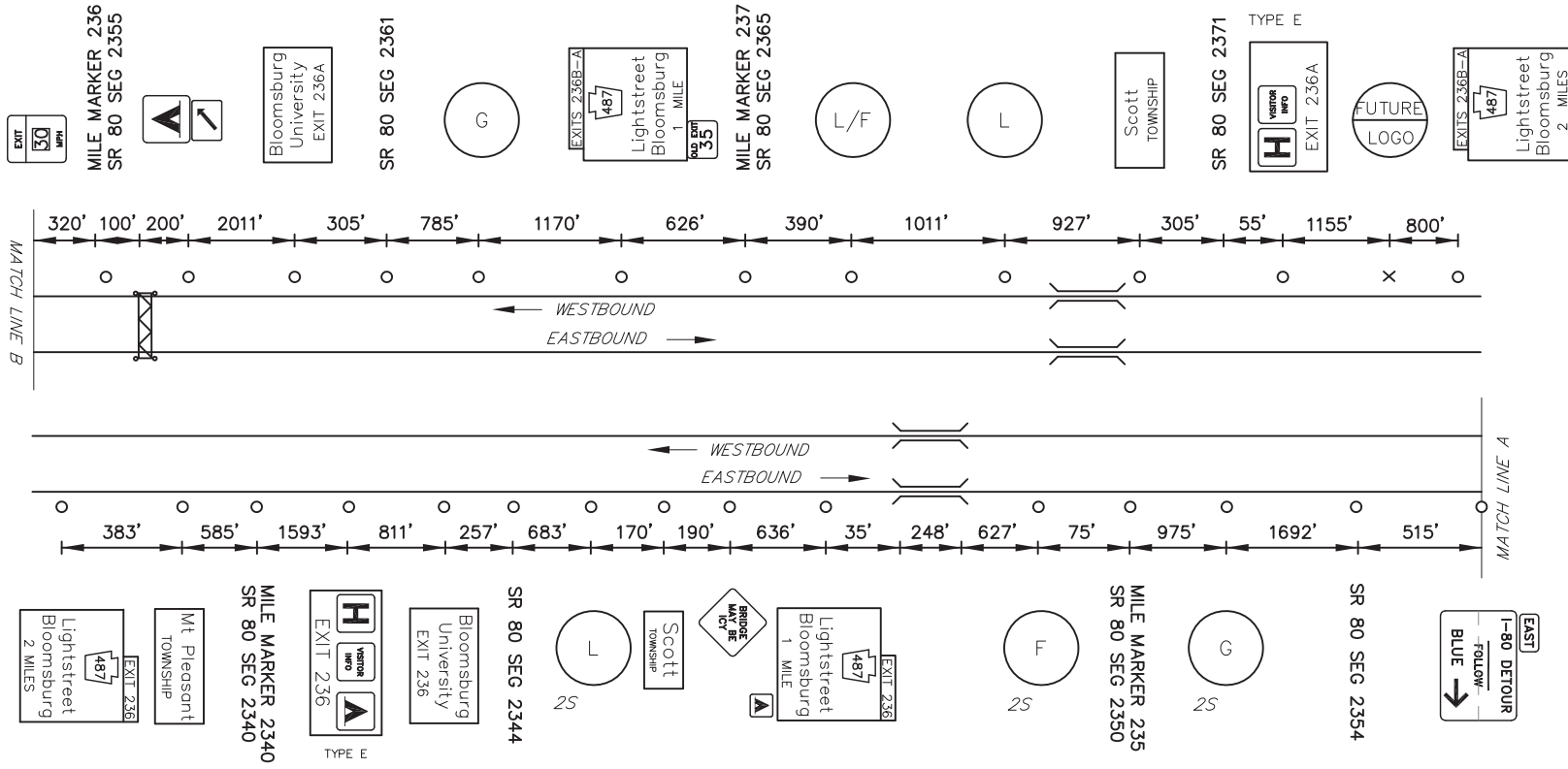

MAINLINE SCHEMATIC  
NOT TO SCALE

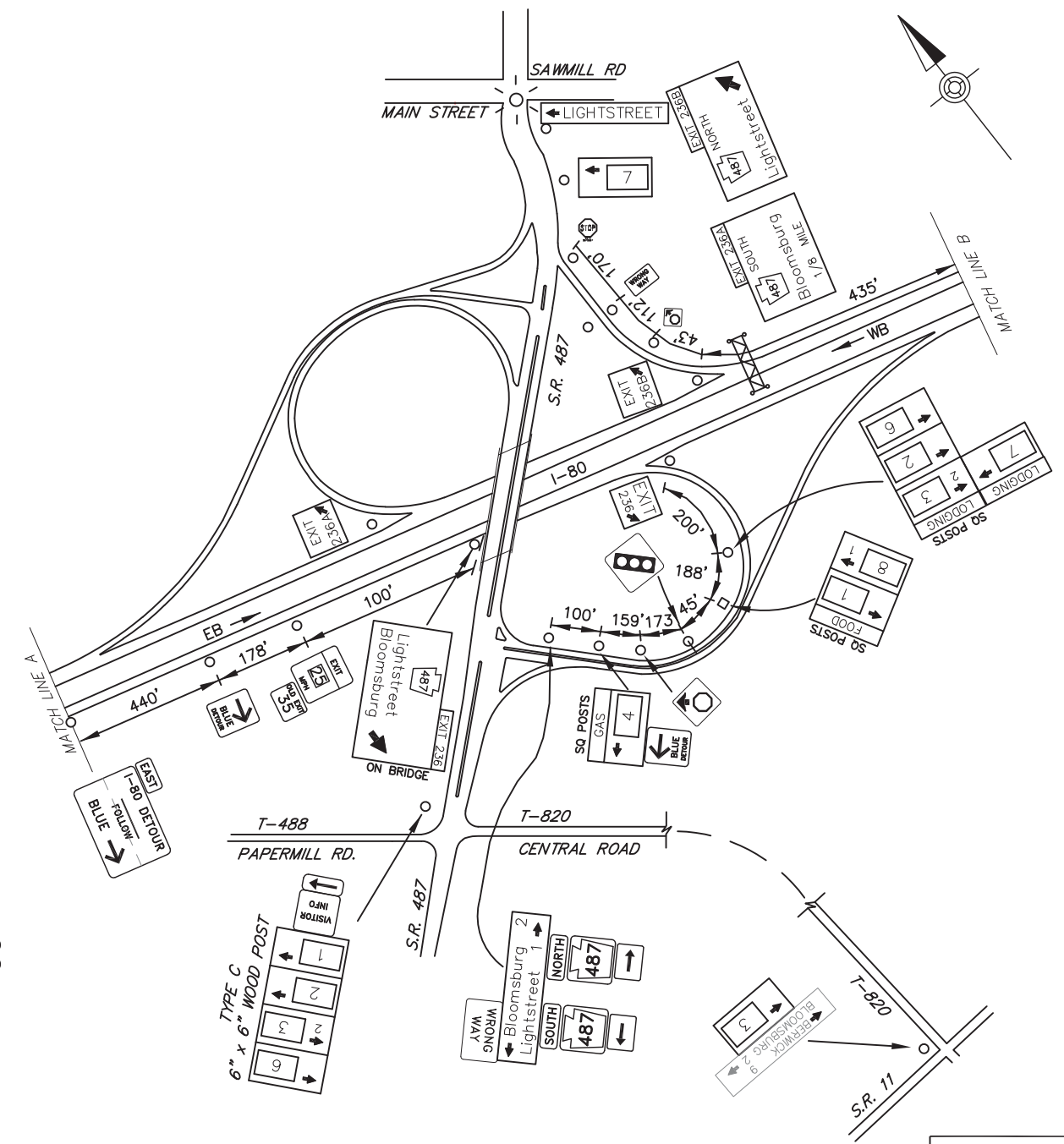

SCHEMATIC PLAN  
NOT TO SCALE

  
**LIGHTSTREET/BLOOMSBURG**  
**EXIT 236**

**LEGEND**

2S - GUIDE RAIL

FREEWAY LANE CLOSURES & RESTRICTIONS ONLY PERMITTED BETWEEN 9:00 PM AND 6:00 AM MONDAY THRU FRIDAY.  
 WORK ALONG FREEWAY PERMITTED BETWEEN 9:00 AM AND 2:30 PM, UNLESS OTHERWISE APPROVED BY ENGINEERING DISTRICT.  
 DO NOT WORK DURING HOLIDAY PERIODS.  
 IF APPLICABLE, REINSTALL GUIDERAIL AT END OF EACH DAY.

EXIT 236 SPECIFIC INFORMATION PANEL			
LEGEND	DIRECTION	BUSINESS	LOGO NO.
FOOD	EB	DENNY'S (24 HOURS)	1
	236A WB		
FOOD	EB	CHESTER'S	8
	236A WB		
GAS	236 EB	SUNOCO (24 HRS)	4
	236A WB		
GAS	236B WB	SUNOCO (DIESEL)	5
	236B WB		
LODGING	EB	RELAX INN	3
	236A WB	HAMPTON INN	2
	236A WB	THE INN AT TURKEY HILL	6
	EB	FAIRFIELD INN	7
236B WB			

**EB SIGNS**

6'Hx16'W  
48"W LOGO  
FUTURE 10'H  
W10x26  
3M TYPE III  
B650 - #1, #1

GAS - EXIT 236  
4

6'Hx13'W  
FUTURE 10'H  
W8x21  
3M TYPE III  
B525 - #2, #1

FOOD - EXIT 236  
1 8

10'Hx13'W  
FUTURE 12'H  
W8x21  
3M TYPE III  
B525 - #2, #1

LODGING - EXIT 236  
2 3  
6 7

**WB SIGNS**

12'Hx16'W  
#4 = 48"W LOGO  
#5 = 60"W LOGO  
W8x18 A572  
3M TYPE III  
B525 - #3, #3

GAS - EXIT 236B  
5  
GAS - EXIT 236A  
4

12'Hx13'W  
W6x15  
3M TYPE III  
B525 - #2, #1

LODGING - EXIT 236B  
7  
FOOD - EXIT 236A  
1

10'Hx13'W  
W10x26  
3M TYPE III  
B650 - #1, #1

LODGING-EXIT 236A  
3 2  
6

\N:\P\ANS\B\B\PROJECTS\2015\B525\2015-01\N\PE\AS-BUILT DRAWINGS\PERMIT DISTRICT 03\COLUMBIA - 1910-XX-SHT-001-001-EXIT236.PLAN  
 11/25/2015 10:43 AM