

DISTRICT	COUNTY	ROUTE	PROJECT	SHEET
3-0	LYCOMING	I-180	LOYALSOCK TOWNSHIP & MOUNTAINBOROUGH	
REVISIONS				

**SYMBOLS**

- Existing Sign to Remain
- △ Existing Sign to be Removed
- ◻ Existing Sign Reset as Shown
- NEW SIGN
- × FUTURE SIGN
- ∅ Existing Utility Pole

**TABULATION OF QUANTITIES**

ITEM	UNIT	QUANTITY
POST MOUNTED SIGNS, TYPE A, LOGO	SQ.FT.	-
POST MOUNTED SIGNS, TYPE B, LOGO	SQ.FT.	-
POST MOUNTED SIGNS, TYPE C, LOGO	SQ.FT.	-
BREAKAWAY SYSTEMS	EACH	-
* STEEL S OR W BEAM POSTS	LBS.	-
LOGO SIGN MOUNTING	EACH	-
EXTRUDED PANEL REPLACEMENT	SQ.FT.	-
REMOVAL OF POST MOUNTED MOTORIST SERVICE SIGNS, TYPES B, C & F	L.S.	-

\* APPROXIMATE QUANTITY FOR INFORMATION ONLY

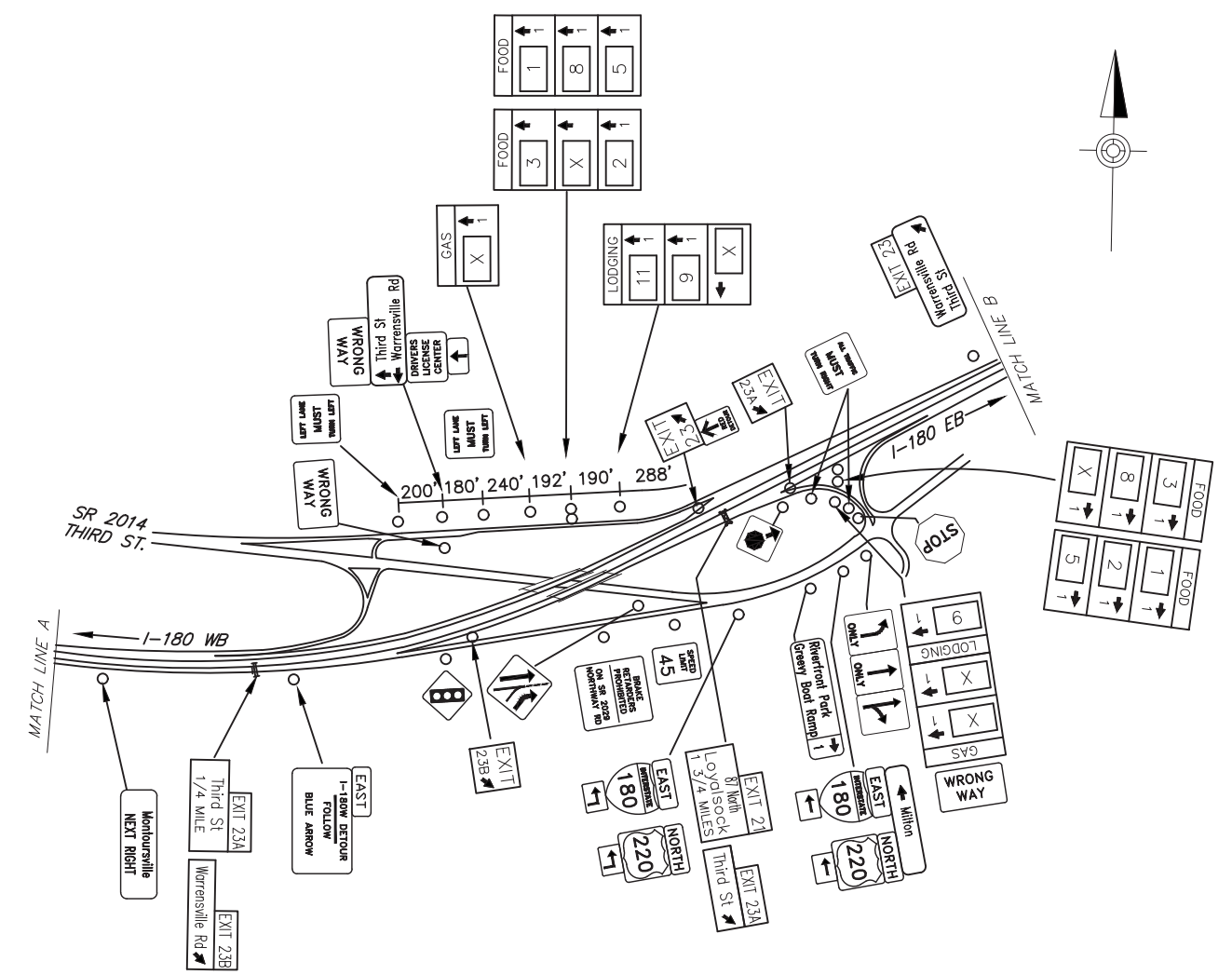
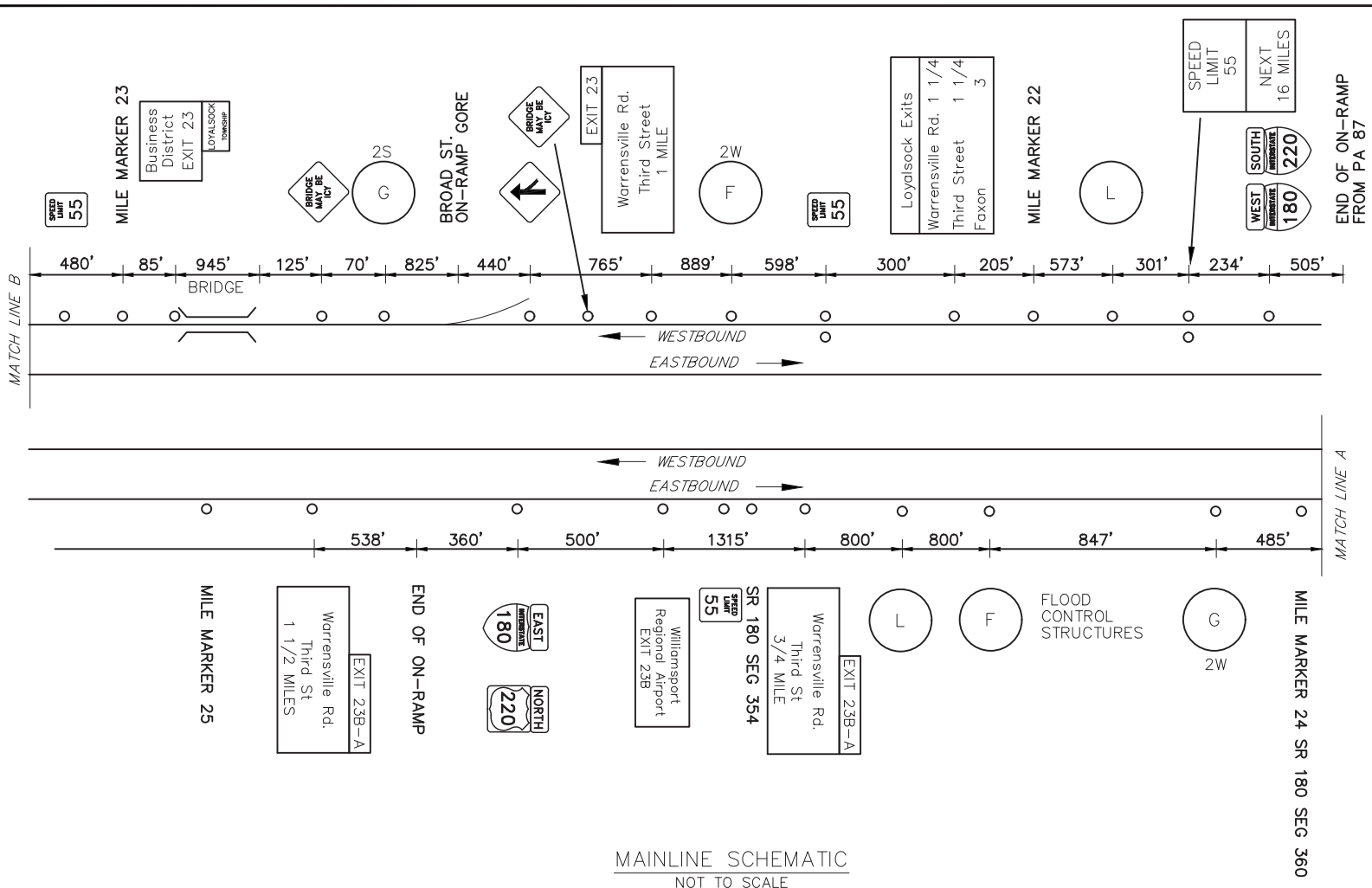

**LEGEND**  
2S/2W - GUIDE RAIL

**EXIT 23 SPECIFIC INFORMATION PANEL**

LEGEND	DIRECTION	BUSINESS	LOGO NO.
GAS	EB/WB		
FOOD	EB/WB	KFC	1
		DUNKIN' DONUTS (24 HRS)	2
		HOSS'S FAMILY STEAK & SEA	3
		RED LOBSTER	5
		TGI FRIDAY'S	8
LODGING	EB/WB	BEST WESTERN	9
	WB	COMFORT INN	11

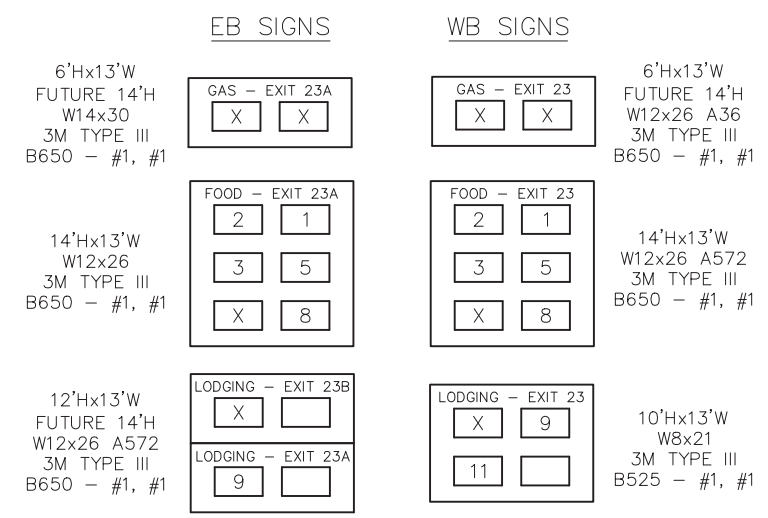

D:\DATA\2014\SR2014\SR2014-180\SR2014-180\_EXIT 23 PLAN.dwg - 4/15/14 3:57:30 PM - 4/15/14 3:57:30 PM