

DISTRICT	COUNTY	ROUTE	PROJECT	SHEET
4-0	WAYNE	I-84		
STERLING TOWNSHIP REVISIONS				

TABULATION OF QUANTITIES		
ITEM	UNIT	QUANTITY
EXTRUDED PANEL REPLACEMENT	SQ.FT.	
POST MOUNTED SIGNS, TYPE B, LOGO	SQ.FT.	
POST MOUNTED SIGNS, TYPE C, LOGO	SQ.FT.	
BREAKAWAY SYSTEMS	EACH	
* STEEL S OR W BEAM POSTS	LBS.	
LOGO SIGN MOUNTING	EACH	
REMOVAL OF POST MOUNTED MOTORIST SERVICE SIGNS, TYPES A & E	EACH	
REMOVAL OF POST MOUNTED MOTORIST SERVICE SIGNS, TYPES B, C & F	L.S.	

* APPROXIMATE QUANTITY FOR INFORMATION ONLY

SYMBOLS	
○	Existing Sign to Remain
△	Existing Sign to be Removed
◻	Existing Sign Reset as Shown
●	NEW SIGN
×	FUTURE SIGN
⊗	Existing Utility Pole

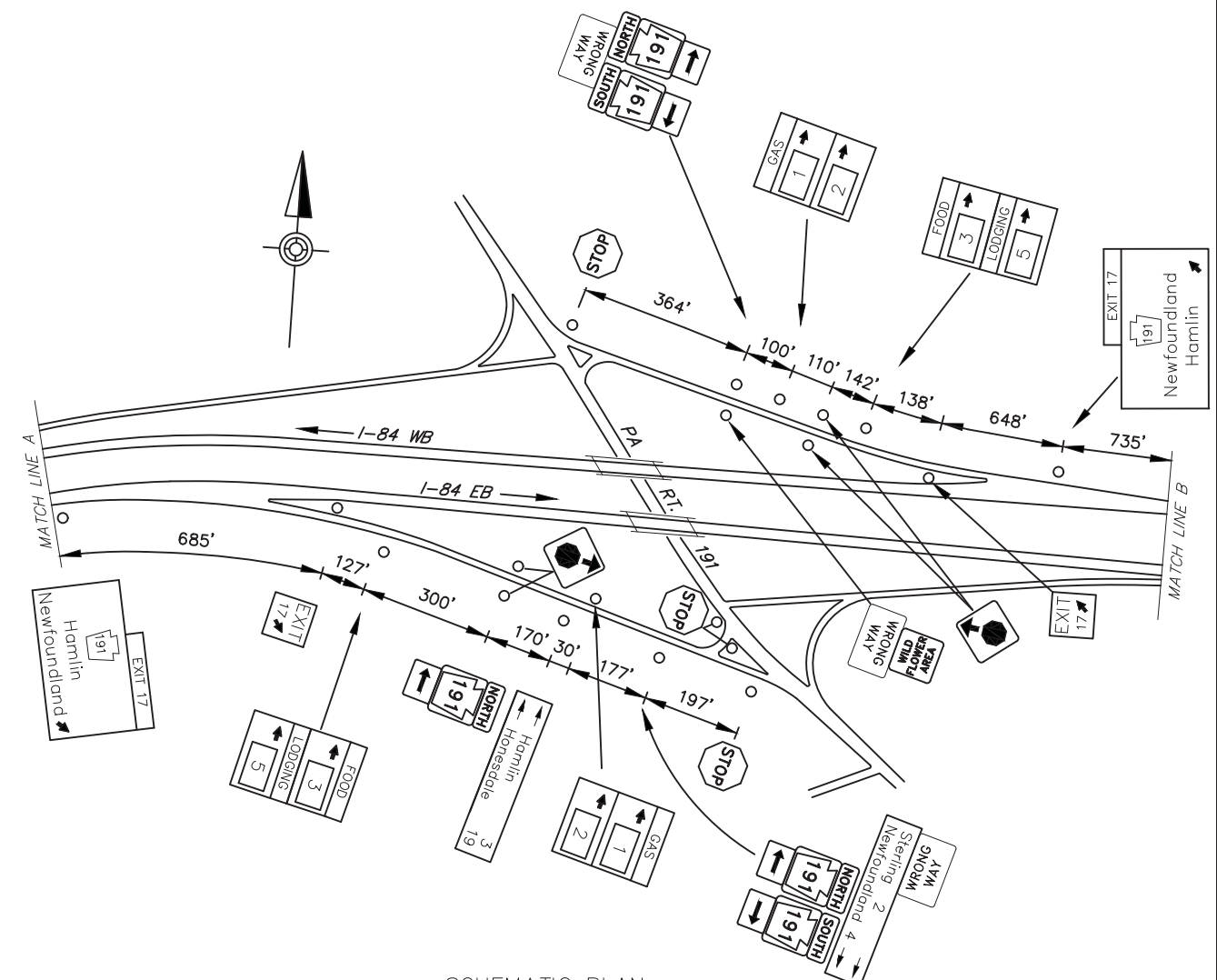
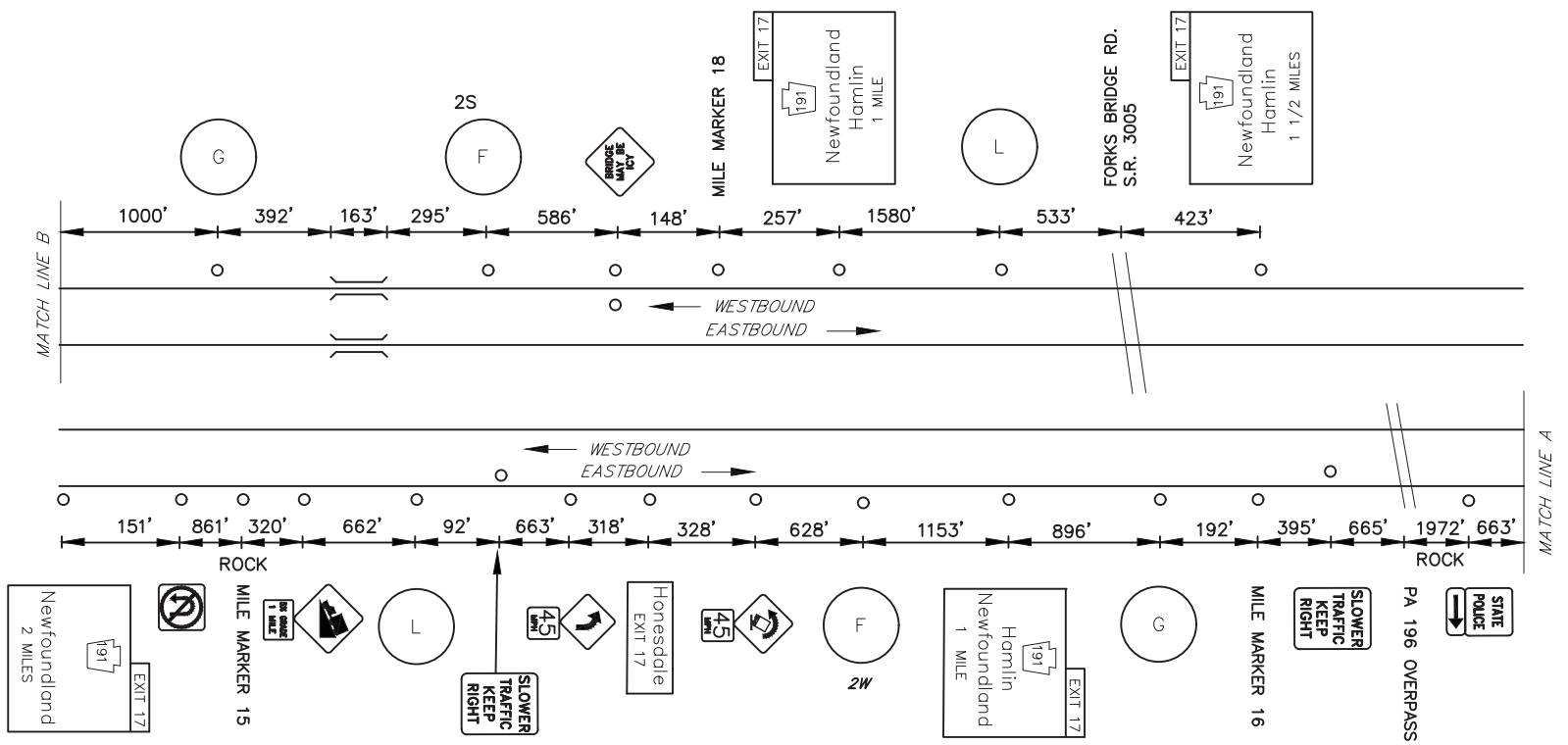

EXIT 17 SPECIFIC INFORMATION PANEL			
LEGEND	DIRECTION	BUSINESS	LOGO. NO.
GAS	EB/WB	EXXON (24 Hrs)	1
		ROADY'S TRUCKSTOPS	2
FOOD	EB/WB	IHOP	3
		COMFORT INN	5
LODGING	EB/WB		

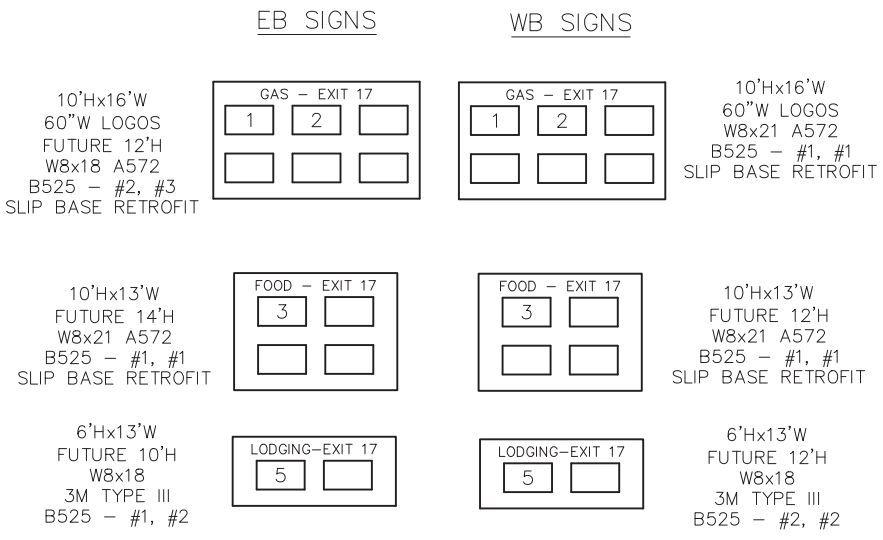

D:\DATA\DESIGN\2024\11\11\WAYNE\45-BUILD\DRAWINGS\PERMITS\DISTRICT 04\WAYNE - 65103-00 SHFX-184-EXIT 17 PLAN
 11/17/2023 12:06 PM