

DISTRICT	COUNTY	ROUTE	PROJECT	SHEET
10-0	BUTLER	US 422		
BUTLER TOWNSHIP REVISIONS				

TABULATION OF QUANTITIES		
ITEM	UNIT	QUANTITY
* STEEL S OR W BEAM POSTS	LBS.	--
BREAKAWAY SYSTEMS	EACH	--
POST MOUNTED SIGNS, TYPE A, LOGO	SQ.FT.	--
POST MOUNTED SIGNS, TYPE B, LOGO	SQ.FT.	--
POST MOUNTED SIGNS, TYPE C, LOGO	SQ.FT.	--
LOGO SIGN MOUNTING	EACH	--

\* APPROXIMATE QUANTITY FOR INFORMATION ONLY

SYMBOLS	
○	Existing Sign to Remain
△	Existing Sign to be Removed
◻	Existing Sign Reset as Shown
●	NEW SIGN
×	FUTURE SIGN
∅	Existing Utility Pole

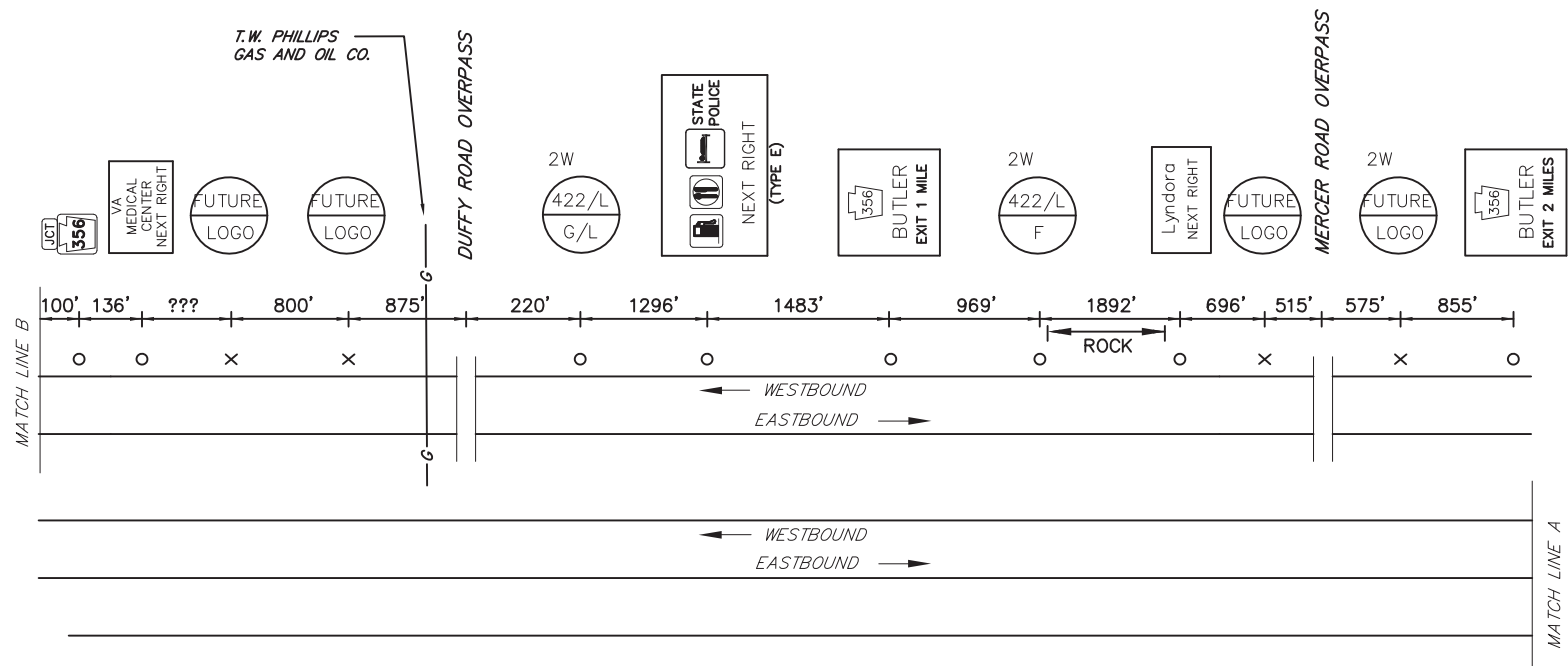

(EASTBOUND NOT ELIGIBLE, INSUFFICIENT SPACE)

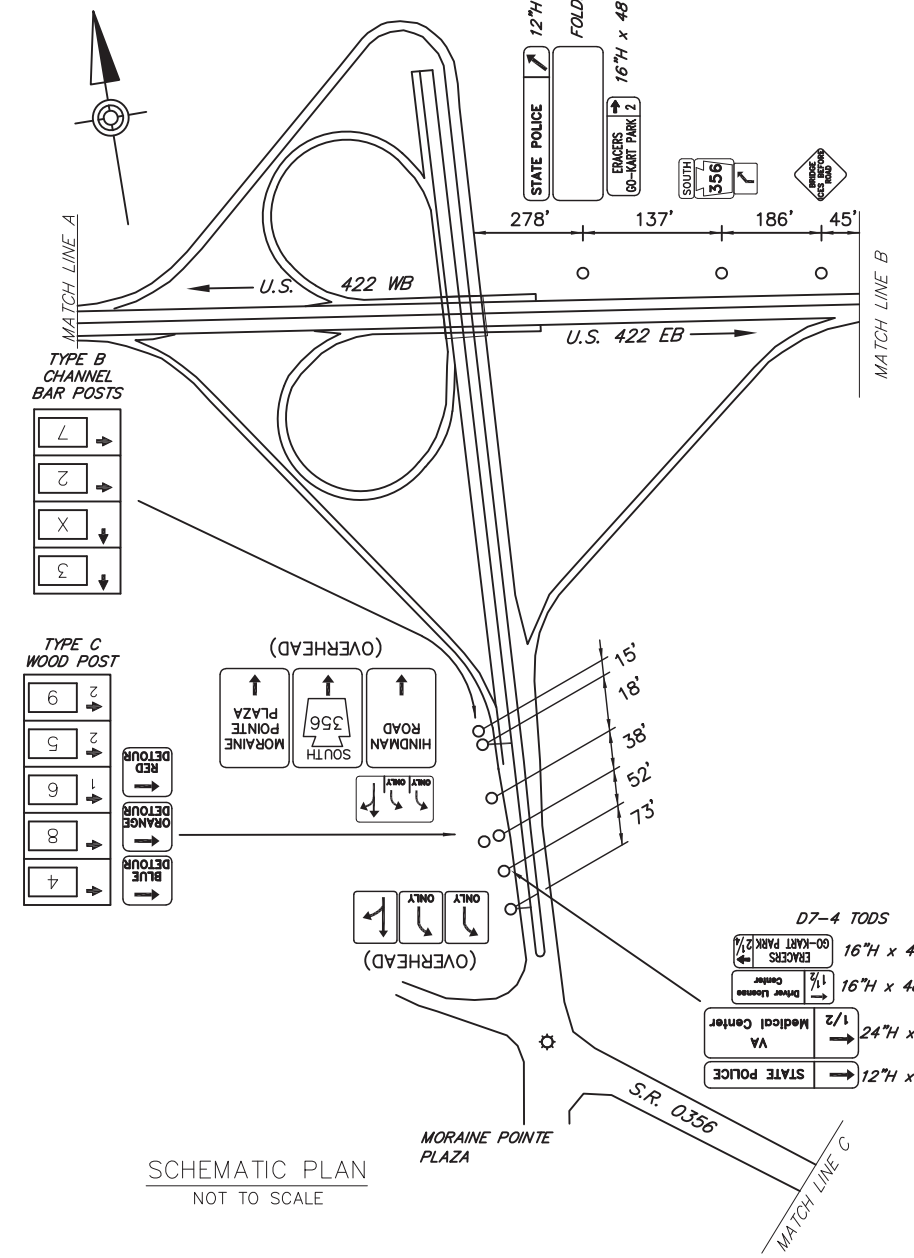
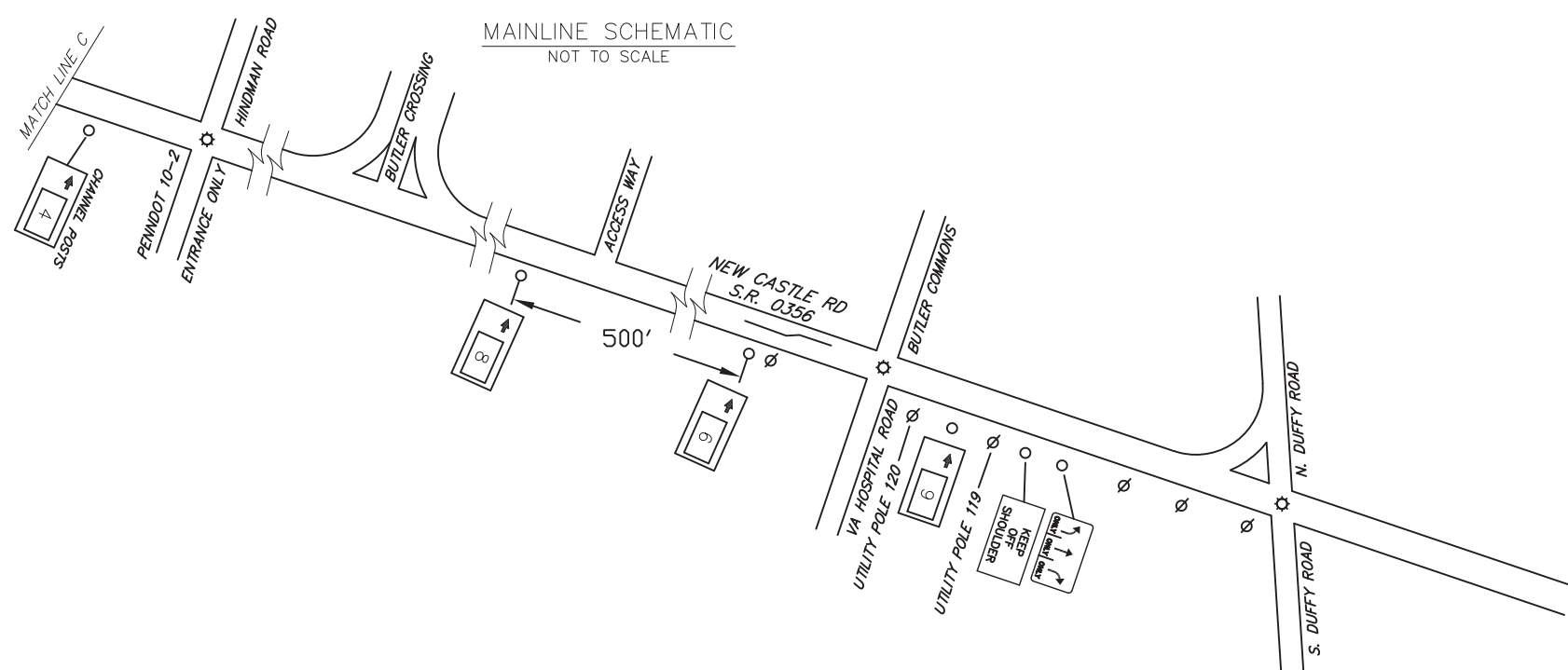

BUTLER/LYNDORA SPECIFIC INFORMATION PANEL			
LEGEND	DIRECTION	BUSINESS	LOGO NO.
GAS	WB	SHEETZ	2
FOOD	WB	RED LOBSTER	3
		McDONALD'S (24 HOURS)	4
		EAT'N PARK (24 HOURS)	5
		PANERA BREAD	6
		APPLEBEE'S	7
LODGING	WB	HAMPTON INN	8
		HOLIDAY INN EXPRESS	9

14'Hx13'W  
W10x22 A572  
STIM. TYPE IV  
B650 - #2, #2

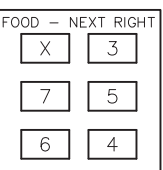

12'Hx13'W  
FUTURE 16'H  
W12x26 A572  
STIM. TYPE III  
B650 - #1, #1



\\\na\projects\10-butler\10-butler-10-10-xx-district-10-butler-10-10-xx-district-10-butler-plan  
 10-10-xx-district-10-butler-plan  
 10/17/2021 2:41 PM

PA RT 356  
 BUTLER/LYNDORA