

DISTRICT	COUNTY	ROUTE	PROJECT	SHEET
3-0	MONTOUR	I-80	VALLEY TOWNSHIP REVISIONS	

SYMBOLS

- Existing Sign to Remain
- △ Existing Sign to be Removed
- Existing Sign Reset as Shown
- NEW SIGN
- × FUTURE SIGN
- Ø Existing Utility Pole

TABULATION OF QUANTITIES

ITEM	UNIT	QUANTITY
POST MOUNTED SIGNS, TYPE A, LOGO	SQ.FT.	---
POST MOUNTED SIGNS, TYPE B, LOGO	SQ.FT.	---
POST MOUNTED SIGNS, TYPE C, LOGO	SQ.FT.	---
BREAKAWAY SYSTEMS	EACH	---
* STEEL S OR W BEAM POSTS	LBS.	---
LOGO SIGN MOUNTING	EACH	---
FLAT SHEET PANEL REPLACEMENT	SQ.FT.	---
EXTRUDED PANEL REPLACEMENT	SQ.FT.	---
REMOVAL OF POST MOUNTED MOTORIST SERVICE SIGNS, TYPES B, C & F	L.S.	---

* APPROXIMATE QUANTITY FOR INFORMATION ONLY

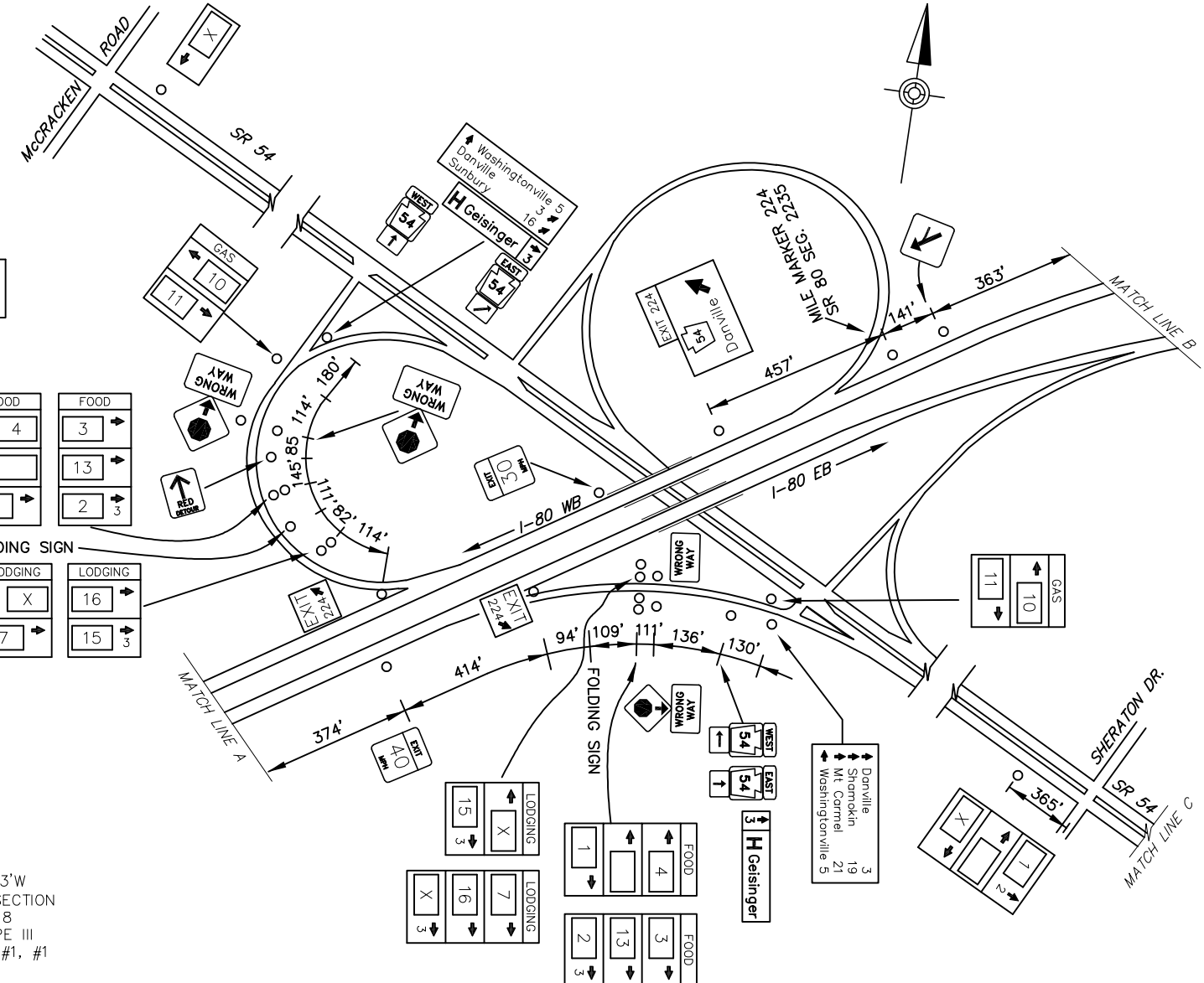
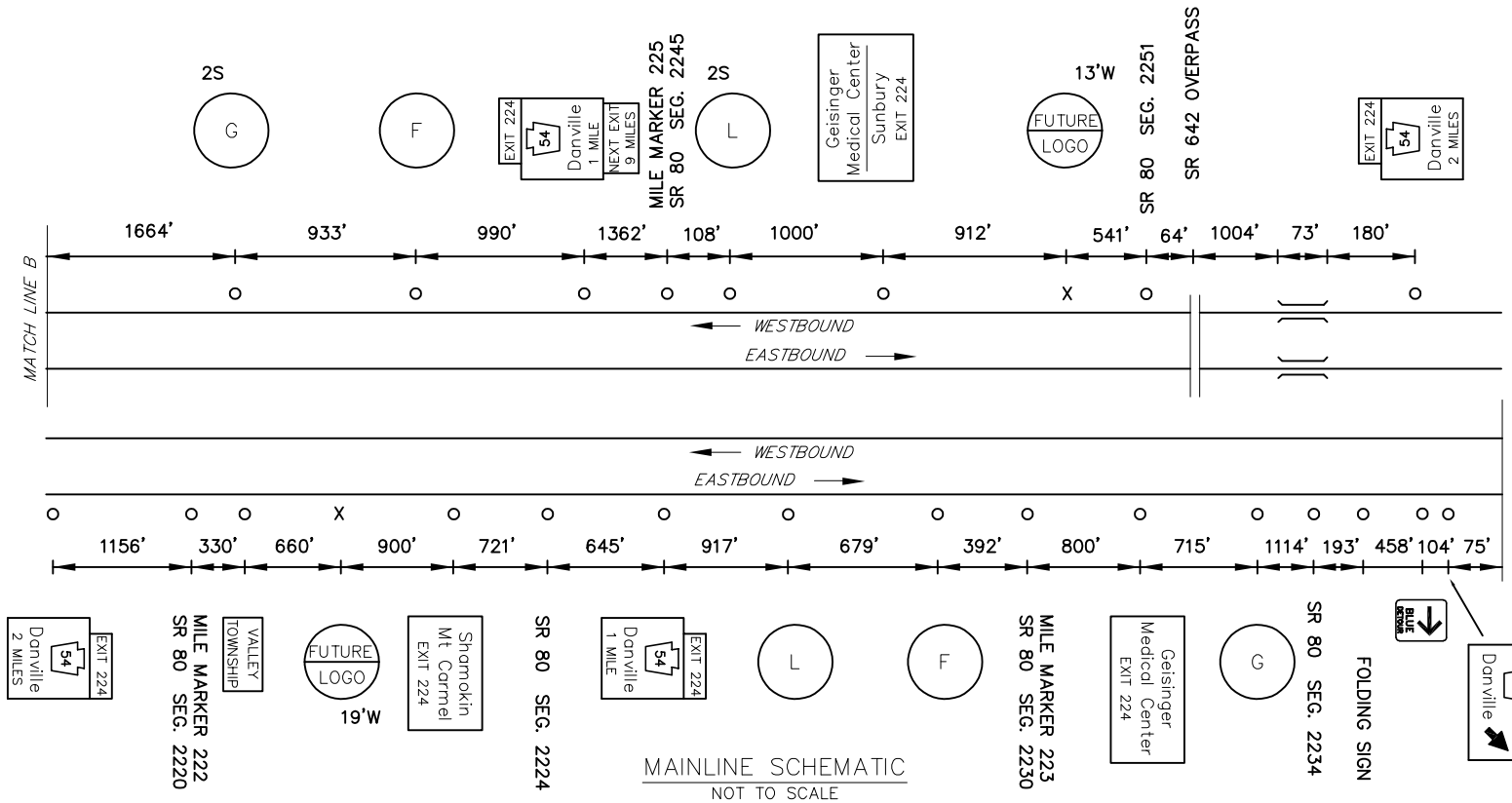

LEGEND

2S - GUIDE RAIL

EXIT 224 SPECIFIC INFORMATION PANEL			
LEGEND	DIRECTION	BUSINESS	LOGO NO.
GAS	EB/WB	EXXON (DIESEL)	10
		MOBIL (DIESEL)	11
FOOD	EB/WB	MCDONALD'S	3
		SUBWAY	4
		PERKIN'S RESTAURANT & BAKERY	1
		FRIENDLY'S	13
		TACO BELL	2
LODGING	EB/WB	RED ROOF INN	7
		SUPER 8	16
		PINE BARN INN	15

EB SIGNS		WB SIGNS	
10'Hx13'W FUTURE 12'H W8x18 3M TYPE III B525 - #1, #2		10'Hx13'W 12' TOP SECTION W8x18 3M TYPE III B525 - #1, #1	
10'Hx19'W W10x26 3M TYPE III B650 - #1, #2		** 10'Hx19'W W10x22 A441 3M TYPE III B650 - #1, #1	
10'Hx19'W W10x26 3M TYPE III B650 - #2, #2		** 10'Hx19'W W8x18 A441 3M TYPE III B525 - #1, #1	

ONE MILE EXTENSION ALLOWANCE APPLIES AT THIS INTERCHANGE

** RESET BY PENNDOT 1994

\\\A0001362\A0001362\DWG\PROJECTS\2015\3-0\VALLEY_TOWNSHIP\SR_54_EXIT_224_PLAN.dwg
 DATE: 7/29/2024 10:59 PM
 DRAWING: PENNDOT - DISTRICT 03 MONITOR - 4710-SR-54-EXIT-224-PLAN

